

THE PROSPECTOR

VOL. 14 NO. 3 CLARK COUNTY NEVADA GENEALOGICAL SOCIETY JULY 1994

**MEMBER
NATIONAL
GENEALOGICAL
SOCIETY**

Preserving for Posterity
since 1976



Dues Increase.....	1
Fall Seminar.....	1
Sunshine.....	1
NV Alert Gen'logists!	2
WARNING	2
Remains relocated	3
Heraldry	3
Family History Societies, England, Wales and Scotland	4
Queries	5
Sources for Data on Irish Research	6
Certificates	6
Pioneer Certificates around the States	7
Member Ahnentafel	8
Addendum to Surnames (Jan 94)	10
UK and Irish Abbreviations	11
Finding Aunt Lillie	12
Federal Land Records, Pt 1	13
On to Richmond	15
Computers	16
Calendar of Events	17
Birth & Death Certificates from Nevada	18
Surname Index	19
Request for Research Assistance	20

CCNGS



LAS VEGAS





Clark County Nevada Genealogical Society

P.O. Box 1929
Las Vegas, Nevada 89125-1929
Voice Mail (702) 225-5838



1993-94 OFFICERS

PRESIDENT

Robert M. Kennard, Jr.

VICE PRESIDENT

Helen Smith

SECRETARY

Phyllis Syzdek

TREASURER

Dick Edmonson

HISTORIAN/SUNSHINE DIRECTOR

Dolores Dimitt

EXECUTIVE DIRECTOR

Linda Robinson McEwen

ONE YEAR DIRECTOR

Margaret Louis

TWO YEAR DIRECTOR

Bruno Syzdek

THREE YEAR DIRECTOR

Barbara Cullings



PROSPECTOR STAFF

Helen Smith - Editor
Margaret Louis
Robert M. Kennard, Jr.
Bruno & Phyllis Syzdek
Joanne Hawkins
Mac Pursel
Dick Edmonson

CCNGS, a non-profit organization, meets on the third Thursday of each month, Katherine Center, Reformation Lutheran Church, 6th and St. Louis, Las Vegas, Nevada, at 7:00 p.m. A business meeting is held, followed by a guest speaker and refreshments. Our purpose is to provide instruction for collecting, preserving and publicizing genealogical, historical and geographical materials.

Yearly membership dues are:
Single \$ 14.00
Family \$ 17.00

Prospector only \$ 8.50

The PROSPECTOR is published quarterly in January, April, July, and October. Copies are free to members and \$2.50 for non-members. A membership list is included in a special January issue.

QUERIES are free to CCNGS members and \$1.00 for non-members. There is a limit of three queries per issue, per person. Queries must be re-submitted to reappear. Deadline for PROSPECTOR material is the 15th of the month prior to the month of issue.

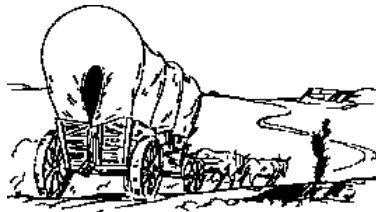

1993-94 CHAIRS

PUBLICITY

Madonna McCarthy
Ken Hill

FUND RAISING

Mac Pursel
Barbara Rosner

EDUCATION

Barbara Cullings

COMPUTER COORDINATOR

Robert M. Kennard, Jr.

SALES TABLE

Mac Pursel

PARLIAMENTARIAN

Frank Lang

MEMBERSHIP

Katie Edmonson

HOSPITALITY/REFRESHMENTS

Madonna McCarthy

LIBRARY

Barbara Cullings - Chair
Bruno & Phyllis Syzdek
Patricia Saye-Barcus

RESEARCH

Dick Edmonson
Edie Kraemer

PIONEER CERTIFICATES

Jeffrey Stevens

The Internal Revenue has ruled that the Society is a tax-exempt Educational and Scientific Organization within the means of Section 501(c) (3) of the Internal Revenue Code of 1954. Consequently donations of funds, library books and other property made to the Society are deductible contributions for the purpose of Federal Income Tax returns.

Dues Increase!



The CCNGS Board of Directors after reviewing expenses proposed an increase to the membership dues, for individuals from **\$12.00** to **\$14.00** and for Couples from **\$15.00** to **\$17.00** a year. Subscription to The Prospector **ONLY** from **\$7.50** to **\$8.50**. This was presented at the April and May meetings and voted on at the June meeting. The increase was approved. For new members increase is effective immediately for current members it takes effect September 1, 1994.

TO WHOM IT MAY CONCERN:

During the April Meeting of CCNGS a member asked for HELP on RACHEL **WRIGHT** and her husband JOHN **LEAVENS**. If you are still interested, please call Harry Burt at 878-3513.

Join **CCNGS** Saturday, October 8, 1994, for an exciting all-day seminar when Richard "Dick" Moore from the American Genealogical Lending Library (AGLL) discusses four informative topics. **"Getting Started Right"** is great for beginners and a refresher for "old-timers". **"Managing a Genealogical Project"** is essential and a genealogist's most difficult goal. **"Finding the Place"** tells where those records are. **"Using Deed Records"** concludes the day with revealing information about the land owner/buyer. Contact CCNGS's voice mail at (702) 225-5838 or write P.O. Box 1929, Las Vegas, NV 89125-1929 for registration and housing information.



SUNSHINE

PAMELA GRAVEN	Jul 1
NANCY MORROW	Jul 4
ROSALIE HART	Jul 9
GALEN GOOD	Jul 11
DIANE GREENE	Jul 12
LAVERNE FAGER	Jul 14
RUTH SOROFMAN	Jul 15
KATHLEEN LANG	Jul 16
DOLORES DIMITT	Jul 20
MARGARET LOUIS	Jul 25
HARRY BURT, JR	Jul 25
NANCY HONEA	Jul 27
ELMER BYRGE	Jul 28
PATRICIA SAYE-BARCUS	Jul 30

MYRON ROSNER	Aug 4
RUSS PRITCHETT	Aug 17
HELEN SMITH	Aug 18
MAC PURSEL	Aug 21
BRUNO SYZDEK	Aug 23
PHYLLIS SYZDEK	Aug 26
MYRTIS VOORHEES	Aug 27
CHRISTENE PRITCHETT	Aug 27

JUNE GORDON	Sep 1
RICHARD EDMONSON	Sep 2
ROCHELLE KENNARD	Sep 14
JOYCE COLLING	Sep 23
WILBUR (BUD) DIMON	Sep 29

ROBIN AMERSON	Oct 1
---------------	-------

NORMA FRANK	Oct 3
DONNA ROBBINS	Oct 6
MARION HAEFNER	Oct 7
BONNIE RAMS	Oct 12
SUSAN WHIPPLE	Oct 13
CATHERINE EDMONSON	Oct 15
MARJORIE BIRK	Oct 16
BARBARA ROSNER	Oct 17
MARY SCAROLA	Oct 24



ANNIVERSARY

ROBERT & ROCHELLE KENNARD JR	Jul 3
FRANK & KATHLEEN LANG	Jul 4
WILBUR (BUD) & JUNE DIMON	Jul 16
HAROLD & JESSIE HEATH	Jul 24

HARLEY & DOROTHY RUSH	Aug 1
HARRY & NELDA BURT, JR	Aug 1
JO ANN & STERLING HAWKINS	Aug 16
HELEN & BRUCE SMITH	Aug 17
VOLA & TODD THORSTEINSON	Aug 26

DIANE & ROBERT GREENE	Sep 3
MYRTIS & JOHN VOORHEES	Sep 16
BRUNO & PHYLLIS SYZDEK	Sep 23

CHRISTIE & MAX DAVIS	Oct 12
ROBERT & LIZ KELLY	Oct 23



PRODIGY(R) interactive personal service

Board: GENEALOGY
Topic: U.S. STATE RESOURCES
Subject: NV ALERT GEN'LGISTS!
To: ALL
Date: 05/28
From: RGGX89A ANNE HALLSTED

There is currently a bill, **AB 3170**, on the State of CA Assembly floor (as of 5/27) which, if enacted, will **1) restrict access to CA BIRTH records until 100 years have elapsed 2) restrict access to CA deaths, marriages, divorces and dissolutions until 50 years have elapsed 3) restrict access to certified copies to ON SITE** (meaning no mail requests) and then only allow **ABSTRACTS**, not the full record with family information **4) require** possessors of any CA vital record **INDEXES** to relinquish them (including FHCs) **5) require "chain of descent"** (and ascent?) for proof of relationship (of course the proof they want might be THAT vital record!)

Additional consequences **1) elimination of jobs at county and state level 2) reduction of income at county and state level currently derived from requests 3) POSSIBLE EMULATION BY OTHER STATES.**

PLEASE WRITE TO THE CALIF. ASSEMBLY AND STATE SENATE AT THE FOLLOWING ADDRESSES IMMEDIATELY IF YOU DON'T WANT THIS INTO LAW!!

Senate: Calif. State Senate, PO Box 942848, Sacramento, CA 94248; Attn: All Senators, Ref: AB 3170
Assembly: Calif. State Assembly, PO Box 942849, Sacramento, CA 94249 Attn: All Assemblymen Ref: AB 3170

If you are a resident of CA, please send your letters to the attention of your local State Senator and Assembly member. If you don't know who they are, look in your phone book under State of CA or call your city hall!!

THIS IS AN EMERGENCY!! WE ARE RUNNING OUT OF TIME!!



WARNING

The New Mexico Genealogical Society has filed a Temporary Restraining Order against Thomas D. Martinez of California.

"Santa Fe Baptisms 1747-1848," "Abiquiu Baptisms 1754-1866," "Santa Cruz de la Canada Baptisms 1710-1854," and "San Juan de Los Caballeros Baptisms 1726-1870" are being sold by Thomas D. Martinez of California, undermining the very purpose of NMGS in that he is disseminating inaccurate and/or unsupported information upon which the general public may mistakenly rely in conducting research.

The Archdiocese of Santa Fe gave NMGS, and only the NMGS, exclusive rights to extract this material from the sacramental registers and publish it. Mr. Martinez is fully aware of this and has been requested by both the Archdiocese of Santa Fe and the New Mexico Genealogical Society to cease publication.

Please write the NMGS at PO Box 8283, Albuquerque, NM 87198-8283 if you have purchased any of these books. Your help will be appreciated.

Remains buried in abandoned cemetery to be relocated

Clark County government plans this fall to relocate the remains buried in an abandoned graveyard near downtown.

The tiny half-acre cemetery is on Foremaster Lane between Las Vegas Boulevard and Main Street and behind the Davis Funeral home. In past years, the cemetery was called Sunset Garden of Memories and Southern Nevada Memorial Veterans Cemetery. It is not associated with the Woodlawn Cemetery located across the street, which will remain intact.

The county acquired the cemetery in 1991 when the owner failed to pay taxes on the property. It has been unable to locate anyone associated with the Reno-based Four K Corp.

The county, heeding the wishes of neighbors, decided to remove the remains from the cemetery, which has become a haven for the homeless and was overrun with weeds.

Family members dismayed by the neglect at the graveyard will be glad to see the matter resolved. "They are glad something's being done, but it is of great concern to them," said Bertha Warrick, a division manager for county social services.

Most of the remains likely will be relocated to one cemetery.

"We're going to be able to put perpetual care in the hands of people who are experienced with perpetual care," said county management analyst Betsy Fretwell. Since July, the county has posted a notice at the cemetery of its plan to disinter those buried there and reinter them elsewhere. It also has published notices in the newspaper.

"The county wants the word out. "We still know there are probably some family members that don't know," Fretwell said.

It also has been attempting to determine who is buried there, and to contact family members. So far, the county has 126 names. The county has estimated that as many as 200 people may have been buried at the cemetery between 1960 and 1975.

For information, call county social services at 455-5722.

—Mary Hynes



CCNGS members became concerned about this cemetery several years ago and began efforts to identify those buried here and to obtain care for the graves. A list of the 66 persons identified at that time appeared on pages 3 and 4 of the January 1990 *Prospector*. Bertha Warwick, supervisor, Clark County Social Services, continues to work on identification of those buried here including matching graves and death certificates. 126 graves have now been identified.

Ms. Warwick expects that identification of remaining graves will be complete in late 1994. We hope to obtain a complete inventory of "Sunset Garden of Memories" or "Southern Nevada Memorial Veterans Cemetery" from Clark County Social Services by the January 1995 issue of the *Prospector*. (There is no relationship between this privately-organized cemetery and the state-operated veteran's cemetery in Boulder City.)



HERALDRY

Coats of arms (sometimes called "family crests" incorrectly) do not extend to all those belonging to the same family or even descendants of a common armigerous ancestor.

The first rule of heraldry is "one person, one coat of arms". This is necessary for a practical reason: during medieval times, when a warrior was in a suit of armor you could not tell who was in the armor. If we have more than one person in armor but using the same coat of arms—then who is inside the armor. In the heat and thick of battle there was not time to go around knocking on the vizor of a man in armor and say "Hello, who's in there?"

For this reason it is not possible to have "family coats of arms". Or any arms which extends to all of one surname. An example, to give just one of hundreds, is the family of Webb. In Burke's General Armory there are listed 26 Webb arms. If your surname was Webb, which would you pick? Or use all 26.... Obviously this is not the approach to ascertaining the correct arms an individual should or may use.

The first way to ascertain a coat of arms is to prove your descent from the armigerous ancestor (that is, the ancestor who first used a coat of arms in your direct male line). If this can not be done, then you can petition an heraldic authority (English King of Arms, Lord Lyon of Scotland, Chief Herald of Ireland, Cronista de Armas in Spain, etc.) for a new grant of arms. Or, you can have designed for yourself a suitable coat of arms and have it copyrighted signed for yourself a suitable coat of arms and have it copyrighted in your name. (The copyright will, however, only protect the particular drawing you use, not the description, which is termed the blazon.) Arms made up by individuals should conform to good heraldic usage. If you are an average U.S. citizen it is inappropriate to turn up with a coat of arms with supporters, and a Crown!

If you wish only to display a coat of arms which you know to have been used by an ancestor, then the most correct way is to have included with the painting or rawing a line clearly visible which says something to the effect "Coat of arms of Sir John Smith, 1683", or whatever. Otherwise it will seem that you are claiming personal use of these arms, which, of course, belonged to that same Sir John Smith in 1683.

Coats of arms are personal property. If you steal one you are taking another's property. Just because you make a photocopy from a book or pay someone to copy one in painted form, unless you use the arms correctly according to heraldic rules you have stolen the arms. In at least one country (Scotland) you can be fined and laced in jail for stealing a coat of arms!

Do not misuse heraldry. It is the color of history, and should be respected and used correctly.

(FROM: The Augustan Society, 1510 Cavens Avenue, Torrance CA 90501)

FEDERATION OF FAMILY HISTORY SOCIETIES IN ENGLAND AND WALES
(Current as of May 1989)

- Blue Mountains Family History Society
Mrs E Lindsay, PO Box 97, Springwood, NSW 2776, Australia

NEW ZEALAND

- New Zealand Society of Genealogists, Inc
PO Box 8795, Auckland 3, New Zealand
- New Zealand Family History Society
Mrs J Lord, PO Box 13301, Armagh, Christchurch, New Zealand
- Genealogical Research Institute of New Zealand, Inc
PO Box 36107, Moera, Lower Hutt, New Zealand
- Guild of One-Name Studies
Box G, 14 Charterhouse Buildings, Goswell Road, London EC1M 7BA



List provided by

The Federation of Family History Societies
Mrs P Saul, Administrator
5 Mornington Close,
Copthorne,
Shrewsbury, SY3 8XN

and transcribed to BFHS.TXT by

Bill Hamilton,
Family Skeletons BBS,
Buckden, England
(0)480-812097

THE SCOTTISH ASSOCIATION OF FAMILY HISTORY SOCIETIES

Hon Secretary,
Miss Lillian Malcolm, 4 Loftus Road, Dundee, DD3 9TE.

Scottish Genealogy Society,
Hon Secretary,
Miss J P S Ferguson,
21 Howard Place,
Edinburgh, EH3 5JY.

Dumfries & Galloway FHS.
Hon Secretary,
Mrs M Roberts,
Magdalene House,
Brown Street,
Lochmaben
Dumfries, DG11 1PD.

Glasgow & West Scotland FHS,
Hon Secretary,
Mr J K Patrick,
11 Gartcows Crescent,
Falkirk, FK1 5QH.

Aberdeen & N E Scotland FHS,
General Secretary,
Family History Shop,
152 King Street,
Aberdeen, AB2 3BD.

Borders FHS,
Hon Secretary,
Mr Peter Ruthven-Murray
Springhill,
Broadmeadows,
Yarrowford,
Nr Selkirk. TD7 5LZ.

Highland FHS,
Hon Secretary,
c/o The Reference Room,
Public Library,
Farraline Park,
Inverness, IV1 1NH.

Tay Valley FHS,
Hon Secretary,
c/o Carlton Gilruth,
Solicitors & Estate Agents
30 Whitehall Street,
Dundee, DD1 4AL.

Anglo-Scottish FHS,
General Secretary,
Mrs Doreen Ramsbotham,
10 Blantyre Road,
Swinton,
Manchester, M27 1ER.



The Scottish Association of Family History Societies was formed in October 1986 to coordinate the promotion of family history in Scotland. Further information may be obtained from the Honorary Secretary. December 1988

REPRINTED from the British, Irish and Welsh JOURNAL of the British Family History Society of Los Angeles, Vol 1, No 4, December 1988, p. 137.



QUERIES

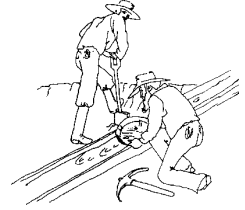

HUMPHREY/HAYDEN

Need info on the children of Theophilus **HUMPHREY** & Cynthia **HAYDEN** of Simsbury CT. who had abt 17 children. Some born in Simsbury. Others (from 1818 on) b. Sheldon, Genesee & Wyoming Co(s) N.Y. Trying to find proof my Homan **HUMPHREY** was their son.

Bev **SILVER** 3012 Hawksdale Dr., Las Vegas, NV 89134 (702)242-5211.

MORTON

Seeking parents of Thomas **MORTON** who d. Ware, Worcester Co., MA in 1805-6. M. Eunice **GRAY** of Greenwich, War, MA, 1790. Jackie **RINALDI** 10013 Netherton Dr., Las Vegas, NV 89134 (702)256-0520

ROGERS

Seeking parents of Henry R. **ROGERS**, b. 1804, d. May 1929, So. Bainbridge (now Afton) Chenango Co. N.Y. M. abt 1823-4 Ann **SLADE**. Had children: Byron, abt 1824; and possibly Mae. Was postmaster of So. Bainbridge.

Jackie **RINALDI** 10013 Netherton Dr., Las Vegas, NV 89134 (702)256-0520

ROOT

Seeking parents of Benjamin **ROOT**, b. 1780 in VT or NH. M. Abigail **WINTERS** of VT. First child, Alonzo **ROOT**, b. No. Hero Island, Lake Champlain, VT, then off to Canada where other children were born. Father was a Loyalist. Please Help! Jackie **RINALDI** 10013 Netherton Dr., Las Vegas, NV 89134 (702)256-0520

STEINER

Looking for parents of Mary Anna **STEINER** and her sister Margaret. Came from area around Karlsruhe Germany abt 1852. Mary Anna m. Sebastian **VOGEL**.

Margaret **LOUIS** 2215 Marlboro Drive Henderson, NV 89014

ROCKHOLD

In Huntington Twnsp and County Pennsylvania Joseph **ROCKHOLD** m. Mary **RICKETTS**; moved to Point Twnsp, Ross Co., Ohio in 1790's. Joseph's father is supposed to have been Nathaniel "a Patriot" in the American Revolution. Need proof of service. Need prior family members. Are

the **ROCKHOLD**'S descended from **RAQUELD** to America on Mary and John? No proof. Walter H. **WALLEY**, C.F.E. Family Genealogist, P.O. Box 351 Sebring OH 44672-0351

DILLY/BURNETT/GIBSON

Seeking info on John **BURNETT**, emigrated from Scotland in early 1900. Settled in Charleston, S.C. Also seeking info on Samuel **DILLY** and wife Agnes **GIBSON DILLY**. Emigrated from Scotland in 1912. **DILLY** & **BURNETT** were half brothers. Edythe **DILLY CRIPE** 4248 Montdale, Las Vegas, NV 89121

LANGDON/WELLS

Seeking any info abt Susan Belle **LANGDON** b. 30 Nov. 1853 in Pennsylvania m. John Emmit **WELLS** of Jamestown, N.Y. d. 12 Feb 1934 in L.A., CA.

Carol **THUN** 6201 Boulder Hwy. Sp.4 Las Vegas, NV 89122

MILLER/WHYTE

Need info on George **MILLER** b. abt 1788 m. 31 Oct 1815 to Marjory **WHYTE** at Saint Katerine Coleman, London, London, England d. 1872. Need info on Marjory **WHYTE** also.

Carol **THUN** 6201 Boulder Hwy. Sp. 4, Las Vegas, Nv 89122

LAING

Seeking info abt Christian **LAING** m. George **MILLER** 28 Jan 1787.

Carol **THUN** 6201 Boulder Hwy. Sp. 4, Las Vegas, NV 89122

ALLAN

Thomas G. **ALLAN** b. 1818 (?) where? d. 11 Apr 1891 Happer, IA. m. Robena **CRAWFORD** 23 Apr 1836 Beith, Scotland. She d. Odell, NE. Son Thomas G. **ALLAN** b. 1839 Scotland (?) where? D. 26 Feb 1894 Washington Kansas. M. Catherine Setella **WELCH** 22 Mar 1861 South English, IA. Daughter Margaret **ALLAN** b. 26 Dec 1840 Beith, Scotland m. 12 Jan 1863. Other children of Thomas and Robena **ALLAN**: son, William b. 1844 N.J.(?); son, John b. 1848 N.J. (?); daughter Janet b. 1856 N.J. (?); and daughter Grace Jane b. 1860 IA. Where were Thomas **ALLAN**, father, and Thomas **ALLAN**, son, born? Where in N.J.

were William, John and Janet born?
Catherine **MARSHALL** 1741 Ferrel St. Las
Vegas, NV 89106-1303

BOUNTY LAND: This was land set aside by state or federal governments for veterans of various American wars, such as the Revolution, the War of 1812 and other early 19th century wars. These lands were located in either individual states (for state bounty awards) or in U.S. owned land of territories (such as Ohio). No bounty lands were authorized for service after the Mexican War.

ENTAIL: Under the old European laws of primogeniture, a landowner could not sell his land or give it away by will. Instead, the land had to remain in the family, being passed on to the eldest son - thus, "entailed." This practice was abolished in the United States by the American Revolution.

HOMESTEAD: Folks often talk about the "old homestead" but that's just a term of endearment. A real homestead was land acquired under the Homestead Law of 1862. That legislation permitted any adult to take up and settle a specific amount of land (a quarter section, or 160 acres) in government-owned land, provided the individual was at least 21 years old and a United States citizen, or had filed a declaration of intent to become a citizen. The only cost was a small fee for filing a claim, and then living on and improving the tract for five years.

METES AND BOUNDS: Until the United States obtained the huge Northwestern Territory and other areas after the Revolution, real estate tracts were measured by compass directions, roads, stream courses, etc. As a result, property lines went all over the map, seldom in a straight line. This type of outlining and surveying of the land became known by the age-old British system of "metes and bounds." After the federal government acquired the Northwestern Territory and other post-Revolution areas of North America, all measurements were by range lines and/or other straight lines of latitude and longitude (rectangular survey). This made it easier to locate property lines.

PRE-EMPTION CLAIMS: For squatters who had settled on land before the Homestead Act era, they could buy their improved plots of real estate for a nominal price per acre.

PRIVATE CLAIMS: These were land grants made to individuals by foreign governments, such as France, Spain, Mexico or Great Britain. When the United States took over those territories, in most instances those prior claims were recognized as legitimate and



Nevada Pioneer Certificate

A framable certificate available to anyone with an ancestor in Nevada before 31 October 1864. Applications available from the **Clark County Nevada Genealogical Society**.



Clark County Settler Certificate

A certificate, honoring those hardy folks who made up those first families of the brand new county of Clark, by their descendants. If your ancestor settled in the Clark County area before 1 July 1909 write for an application from **CCNGS**.



Early Las Vegas Certificate

Did your family come to Las Vegas before 16 March 1911? If so they were an Early Las Vegas. Applications are available from **CCNGS**.



Nevadan

Were you born in Nevada before March 16, 1931 (date that Gambling was legalized in Nevada), "A turning point in Nevada's Future. **CCNGS** has a certificate to honor you.

valid, and the possessors could keep their lands.

PUBLIC DOMAIN: These were any unsettled land in this country which was not allocated for any other purpose, such as military tracts, railroad grants or an Indian reservation, etc. It was from this huge chunk of land that the above-mentioned homestead tracts were given out.

From: Ralph Briggs

"Sources for Data on Irish Research"
Henderson Home News, May 26, 27, 1994.

PIONEER CERTIFICATES AROUND THE STATES

ARIZONA:

The Arizona Genealogical Advisory Board (AZGAB) announced that it is offering an attractive Pioneer Certificate to anyone who wishes to commemorate an ancestor who resided in the area that is now the State of Arizona prior to Statehood (February 14, 1912). Certificates will be numbered and will be printed on heavy parchment paper with individual information printed in calligraphic hand. For application forms send two \$.29 stamps to the project chairperson, Joella Cheek, HC 29, Box 359, Prescott, Arizona 86301.

ARKANSAS:

Three categories of certificates are offered by the Arkansas Genealogical Society: (1) Territorial (resident prior to 15 Jun 1836), (2) Antebellum (resident before 6 May 1861), and (3) Nineteenth Century (before 31 Dec 1900). For an application or more information, send \$.52 in stamps to Desmond Walls Allen, Certificate Chairman, 99 Lawrence Landing Rd., Conway, Arkansas 72032.

IOWA:

Anyone whose ancestor settled in the state in 1856 or before can apply to the Iowa Genealogical Society, P.O. Box 7735, Des Moines, IA 50322. The present collection was filmed by the Genealogical Society of Utah in July 1987, but it continues to grow at the rate of 200 new additions per year and now totals 3500.

MICHIGAN:

The Grand Traverse Area Genealogical Society offers an Ancestral Family Certificate to direct descendants of settler of the area 100 years ago, or more. An Early Settlers Certificate is offered for settlers before 1860. An additional seal is affixed to the Early Settlers Certificate for families which have been in continuous residence since 1860. The area includes Antrim Co, Benzie Co, Grand TGraverse Co, Kalkaska Co, Leelanau Co, Circle Co. Write the society c/o Brenda K. Wolfgram Moore, 430 S. Airport Road East, Traverse City, MI 49684 for additional information.

NEW MEXICO:

First Families of New Mexico, sponsored by the NM State Genealogical Society, recognizes descendants of several categories of pioneers including (1) Native Americans, (2) The Onate Period 1598-1680, (3) The Reconquest 1692-1821, (4) the Mexican period 1821-1846, and The Territorial period 1846-1912. Apply to the Society at P.O. Box 8283, Albuquerque, NM 87198-8283.

NEVADA:

See previous page.

OHIO:

Membership in the First Families of Ohio is open to members of the Ohio Genealogical Society who are direct descendants of settlers of the area which is now the State of Ohio before 1820. Extensive proof is required along with an application fee of \$30. Write the state society at P.O. Box 2625, Mansfield, OH 44906.

Guernsey County offers membership in the First Families of Guernsey County to anyone whose ancestors settled there before 1830. Send two \$.29 stamps to First Families, Guernsey County Genealogical Society, Courthouse Annex, 836 Steubenville Ave., Cambridge, OH 43725-2399 for application.

Lucas County has three categories for membership: Pioneer, for ancestors who resided in the present area of that county before 1 Jan 1851; Settler, before 31 Dec 1870, and Centennial, not less than 100 years prior to application (e.g., 1892 for membership in 1992). Memberships applications and requirements for documentation are available from Jean Kesler Scherer, 5320 Harvest Lane, Toledo, OH 43623.

TEXAS:

Tom Green County certificate available at cost of \$10 per ancestor. For information send SASE to The San Angelo Genealogical and Historical Society, Inc., P.O. Box 3453, San Angelo, TX 76902.

WASHINGTON:

Pioneer Certificate is offered if pioneer ancestor was in the state before 11 Nov 1889; First Citizen Certificate if before 31 Dec 1900. For details contact Washington State Genealogical Society, P.O. Box 1422, Olympia, Wa 98507.



MEMBERMENTAL

Prepared by: Barbara (PROSCH) CULLINGS
1728 Kassabian Avenue
Las Vegas, Nevada 89104
(702) 735-1688

1st GENERATION

- 1 Barbara Jean **PROSCH**, occ. Librarian, b. 30 Nov 1933 in Omaha, Douglas Co., Nebraska NE, re. in Las Vegas, Clark Co., Nevada NV, ma. 27 Dec 1963 in Downey, Los Angeles Co., California CA, ref: 3.

2nd GENERATION

- 2 Ben L. **PROSCH**, occ. Indust.Relations, b. 22 Jun 1902 in Morgan Twp., Crawford Co., Iowa IA, d. 27 Feb 1990 in Camarillo, Ventura Co., California CA, ma. 24 May 1930 in Lincoln, Lancaster Co., Nebraska NE, ref: 6.
- 3 Julia **ALLAM**, b. 29 Sep 1905 in Del Norte, Rio Grande Co., Colorado CO, d. 8 Feb 1984 in Del Norte, Rio Grande Co., Colorado CO, ref: 7.

3rd GENERATION

- 4 John Friederich **PROSCH**, occ. Farmer, b. 2 Mar 1862 in Fredesdorf, Segeberg, Sch-Holstein, Germany, d. 30 Mar 1950 in Bloomfield, Knox Co., Nebraska NE, ma. 27 Mar 1887 in Denison, Crawford Co., Iowa IA, ref: 12.
- 5 Dorothea Catharina **KROHN**, occ. Housewife, b. 27 Nov 1862 in Hoherdamm, Holstein, Germany, d. 28 Mar 1948 in Bloomfield, Knox Co., Nebraska NE, ref: 13.
- 6 Thomas George **ALLAM**, occ. Bar/HotelOwner, b. 17 May 1876 in Syria (Lebanon), d. 22 May 1938 in Del Norte, Rio Grande Co., Colorado CO, ma. in Denver, Colorado CO, ref: 14.
- 7 Naiphie **SAIDY**, b. 4 Dec 1883 in Fourzol, Bekaa Valley, Syria (Lebanon), d. 13 Nov 1947 in Del Norte, Rio Grande Co., Colorado CO, ref: 15.

4th GENERATION

- 8 Johann Hinrich **PROSCH**, occ. Farmer, b. 14 Jan 1830 in Fredersdorf, Segeberg, Sch-Holstein, Germany, d. 21 Jan 1909 in Ida Grove, Ida Co., Iowa IA, ma. 26 Oct 1851 in Segeberg, Sch-Holstein, Germany, ref: 24.
- 9 Catharina **MOELLER**, b. 1 Oct 1823 in Fredesdorf, Segeberg, Sch-Holstein, Germany, d. 25 Dec 1910 in Ida Grove, Ida Co., Iowa IA, ref: 25.
- 10 Hans Detlef **KROHN**, occ. Farmer, b. 12 May 1831 in Tønningstedt, Holstein, Germany, d. 12 Apr 1910 in Randolph, Cedar Co., Nebraska NE, ma. 6 Aug 1858 in Tønningstedt, Schleswig-Holste, Germany, ref: 26.
- 11 Anna Catharina Friederica **KROEGER/KRUEGER**, b. 31 Jan 1838 in Sulfeld, Schleswig-Holste, Germany, d. 15 Jan 1908 in Randolph, Cedar Co., Nebraska NE, ref: 27.
- 12 George (Jurious) **ALLAM (SABAGH)**, b. in Dahria, Lebanon, ref: 28.
- 13 Satute (Julia) **DAHIR**.
- 14 Hannah (John) Moses **SAIDY**, b. in Fourzol, Syria (Lebanon), d. in Fourzol, Syria (Lebanon), ref: 30.
- 15 Raheel Tanous (Thomas) **SAIDY**, b. 1860 (?) in Biskanta, Syria (Lebanon), d. 1940 (?) in Fourzol, Syria (Lebanon).

5th GENERATION

- 16 Hans Friedrich **PROSCH**, occ. Peasant, b. 19 Mar 1794 in Jersbeck, Segeberg, Sch-Holstein, Germany, d. 20 Mar 1870 in Segeberg, Sch-Holstein, Germany, ma. 29 Apr 1823 in Segeberg, Sch-Holstein, Germany, ref: 48.
- 17 Anna Katharina **KLOOK**, b. 5 Feb 1786 in Fredesdorf, Segeberg, Sch-Holstein, Germany, d. 29 Nov 1842 in Fredesdorf, Segeberg, Sch-Holstein, Germany, ref: 49.
- 18 Hinrich **MOELLER**, occ. Farmer, b. 1 Mar 1773 in Fredesdorf, Segeberg, Sch-Holstein, Germany, d. 6 May 1839 in Fredesdorf, Segeberg, Sch-Holstein, Germany, ma. 4 Mar 1820 in Segeberg, Sch-Holstein, Germany, ref: 50.
- 19 Magdalena **STEINBOCK**, b. 26 Dec 1788 in Todesfelde, Segeberg, Sch-Holstein, Germany, d. 29 Mar 1856 in Fredesdorf, Segeberg, Sch-Holstein, Germany.
- 20 Hans Detlef **KROHN**, occ. FullFarmer, b. 8 Jan 1808 in Toenningstedt, Holstein, Germany, ma. 26 Oct 1833 in Leezen, Holstein, Germany, ref: 52.
- 21 Christina (Anna) Maria **STOLTEN**, b. 3 Sep 1810 in Toenningstedt, Holstein, Germany.
- 22 Johann Hinrich **KROEGER**, b. 18 Mar 1787 in Polka, b. Wittenberg, Sch-Holstein, Germany, d. 28 Jul 1852 in Sulfeld, Sulfeld, Sch-Holstein, Germany, ma. 10 Jul 1819, ref: 54.
- 23 Anna Dorothea **TEGEN**, b. 14 May 1799 in Oehring, Sulfeld, Sch-Holstein, Germany, d. 4 Jul 1877 in Sulfeld, Sch-Holstein, Germany.
- 28 Jack (Yaop) **SAIDY**, b. in Fourzol, (Lebanon) Syria, d. in Fourzol, (Lebanon) Syria, ref: 60.
- 30 Thomas (Tanous) **SAIDY**, b. in Fourzol, (Lebanon) Syria, d. 1906 in Fourzol, (Lebanon) Syria, ref: 62.
- 31 Turkman Anton **SAIDY**, b. in Fourzol, (Lebanon) Syria, d. 1907 (?) in Fourzol, (Lebanon) Syria.

6th GENERATION

- 32 Johan Christopher **PROSCH**, occ. BarnOverseer, b. 1734 (?), d. 4 Apr 1808 in Bargteheide, Storman, Sch-Holstein, Germany, ref: 96.
- 33 Elisabeth **LESAU**, b. 1748 in Bargfeld, d. 20 Oct 1808 in Bargfeld, Segeberg, Sch-Holstein, Germany.
- 34 Klaus **KLOOK/KLOK**, ma. 23 Nov 1784 in Segeberg, Sch-Holstein, Germany, ref: 98.
- 35 Anna Catharina (Katrina) **SCHMALFELD**, b. 1758, d. 17 Nov 1822 in Fredesdorf, Segeberg, Sch-Holstein, Germany, ref: 99.
- 36 Johann **MOELLER**, occ. HalfFarmer, ma. 18 Oct 1771 in Segeberg, Sch-Holstein, Germany, ref: 100.
- 37 Anna Magdalena **KOCK**, b. 2 Feb 1742/3 in Fredesdorf, Segeberg, Sch-Holstein, Germany, d. 24 Jan 1802 in Fredesdorf, Segeberg,

NOTE: ALL ARTICLES TO BE SUBMITTED FOR THE OCTOBER, 1994 ISSUE OF THE PROSPECTOR MUST BE RECEIVED BY SEPTEMBER 15, 1993. ARTICLES CAN BE SUBMITTED ON COMPUTER DISK IN AN ASCII FORMAT.

MAIL TO:

**C.C.N.G.S. PROSPECTOR
ATTN: EDITOR
P.O. BOX 1929
LAS VEGAS, NEVADA 89125-1929**

ADDENDUM:

SURNAMES BEING RESEARCHED BY CCNGS MEMBERS - JANUARY 1994

SURNAME	LOCATION	MEMBER
AUSTIN	NC TX	275
BALKE	GERMANY	296
BENTZ	OH CA	275
BRIZENDINE	TN	316
CORCORAN	GERMANY	275
CROSBY	SD IA WI	296
CUPP	TN	313
DWYER	NJ	313
FARRELL	IRELAND	275
FREITAG	GERMANY	296
GAYTON	NJ NE AR CA	313
GILLIGAN	IRELAND	275
GRAVES	MA CT	296
GRIFFITH	IN SC	313
HARRISON	ND SD MT	296
KLINETOB	PA IL GERMANY	296
KOSTESCH	SD RUSSIA	296
LAMBERT	OH GERMANY	275
LARSON	MN WA NORWAY	296
MADDOX	TX	275
MATHIS	TN	316
McCLAIN	IA KS TX CA	275
OWEN	IN MO AR	313
PIERCE	NE TX	321
PIPKINS	TX	321
REDDY	NJ IRELAND	313
SHEA	MO IRELAND	316
SHOKS	OH GERMANY	275
SKYRLOCK	AR CA IL INDIAN TERRITORY	313
SMITH	TN	321
THOMPSON	OK	321
VOORHEES	NJ	313
WOLPERS	MN WA GERMANY	296

CCNGS MEMBERS MENTIONED ABOVE

#	FIRST NAME	LAST NAME	ADDRESS	CITY	ST	ZIP	PHONE
265	RAYMOND	SIMPSON	6413 BAMBOO PLACE	LAS VEGAS	NV	89108	645-3971
275	JOSEPH	BENTZ	4550 W SAHARA #1135	LAS VEGAS	NV	89102	870-3996
296	VOLA	THORSTEINSON	479 So CHESAPEAKE WAY	HENDERSON	NV	89015	564-1925
313	MYRTIS	VOORHEES	2524 SPRINGRIDGE DRIVE	LAS VEGAS	NV	89134	254-4547
316	PAULA JEAN	BRUER	3643 DANA WAY	LAS VEGAS	NV	89103	
321	MICHELLE L	SMITH	6616 ROY ROGERS DRIVE	LAS VEGAS	NV	89108	645-3566

United Kingdom & Irish ABBREVIATIONS

by Brian Randell

Dept. of Computing Science, University of Newcastle, Newcastle upon Tyne, NE1 7RU, UK

Aberdeenshire/ABD/	Glamorganshire/GLA/	North Yorkshire/NYK/
Alderney/ALD/	Glamorgan/GLA/	Northampton/NTH/
Anglesey/AGY/	Gloucestershire/GLS/	Northern Ireland/NIR/
Angus/ANS/	Grampian/GMP/	Northumberland/NBL/
Antrim/ANT/	Guernsey/GSY/	Nottinghamshire/NTT/
Argyllshire/ARL/	Gwent/GNT/	Offaly/OFF/
Armagh/ARM/	Gwynedd/GYN/	Orkney Isles/OKI/
Avon/AVN/	Hampshire/HAM/	Oxfordshire/OXF/
Ayrshire/AYR/	Herefordshire/HEF/	Peebleshire/PEE/
Banffshire/BAN/	Hertfordshire/HRT/	Pembrokeshire/PEM/
Bedfordshire/BDF/	Highlands/HIL/	Perthshire/PER/
Berkshire/BRK/	Home Counties/HMC/	Powys/POW/
Berwickshire/BEW/	Humberside/HUM/	Radnorshire/RAD/
Breconshire/BRE/	Huntingdonshire/HUN/	Renfrewshire/RFW/
Buckinghamshire/BKM/	Inverness-shire/INV/	Roscommon/ROS/
Bute/BUT/	Ireland/IRL/	Ross & Cromarty/ROC/
Caernarvonshire/CAE/	Isle of Harris/HAR/	Roxburghshire/ROX/
Caithness/CAI/	Isle of Man/IOM/	Rutland/RUT/
Cambridgeshire/CAM/	Isle of Wight/IOW/	Sark/SRK/
Cardiganshire/CBN/	Jersey/JSY/	Scotland/SCT/
Carlow/CAR/	Kent/KEN/	Selkirkshire/SEL/
Carmarthenshire/CMN/	Kerry/KER/	Shetland Isles/SHI/
Cavan/CAV/	Kildare/KID/	Shropshire/SAL/
Channel Isles/CHI/	Kilkenny/KIK/	Sligo/SLI/
Cheshire/CHS/	Kincardineshire/KCD/	Somerset/SOM/
Clackmannanshire/CLK/	Kinross-shire/KRS/	South Wales/SWL/
Clare/CLA/	Kircudbrightshire/KKD/	South Yorkshire/SYK/
Cleveland/CLV/	Lanarkshire/LKS/	Staffordshire/STS/
Clwyd/CWD/	Lancashire/LAN/	Stirlingshire/STI/
Cork/COR/	Leicestershire/LEI/	Strathclyde/STD/
Cornwall/CON/	Leitrim/LEI/	Suffolk/SFK/
Cumberland/CUL/	Leix/LEX/	Surrey/SRY/
Cumbria/CMA/	Limerick/LIM/	Sussex/SSX/
Denbighshire/DEN/	Lincolnshire/LIN/	Sutherland/SUT/
Derbyshire/DBY/	London/LND/	Tayside/TAY/
Devonshire/DEV/	Londonderry/LDY/	Tipperary/TIP/
Devon/DEV/	Longford/LOG/	Tyne & Wear/T&W/
Donegal/DON/	Lothian/LTN/	Tyrone/TYR/
Dorset/DOR/	Louth/LOU/	Wales/WLS/
Down/DOW/	Mayo/MAY/	Warwickshire/WAR/
Dublin/DUB/	Meath/MEA/	Waterford/WAT/
Dumfriesshire/FDS/	Mercia/MCA/	Wessex/WSX/
Dunbartonshire/DNB/	Merionethshire/MER/	West Country/WCY/
Durham/DUR/	Merseyside/MSY/	West Lothian/WLN/
Dyfed/DFD/	Mid-Glamorgan/MGM/	West Midlands/WMD/
East Anglia/EAG/	Middlesex/MDX/	West Riding/WRY/
East Lothian/ELN/	Midlands/MID/	West Sussex/SXW/
East Riding/ERY/	Midlothian/MLN/	West Yorkshire/WYK/
East Sussex/SXE/	Monaghan/MOG/	Western Isles/WIS/
East Yorkshire/EYK/	Monmouthshire/MON/	Westmeath/WEM/
England/ENG/	Montgomeryshire/MGY/	Westmoreland/WES/
Essex/ESS/	Moray/MOR/	Wexford/WEX/
Fermanagh/FER/	Nairnshire/NAI/	Wicklow/WIC/
Fifeshire/FIF/	Norfolk/NFK/	Wigtownshire/WIG/
Flint/FLN/	North Riding/NRY/	Wiltshire/WIL/
Galway/GAL/	North Wales/NWL/	Worcestershire/WOR/

Finding Aunt Lillie

When friends ask how I spend spare time and I reply, "Genealogy," they give me one of those looks that says, "Get a life."

I did. Her name is Aunt Lillie. It's true. I spend cheerful, sunny weekends in research libraries, my head inside the box of a microfilm projector. Its light bulb is my lamp down dark corridors of time, shining on the tracks of my family who spent two centuries moving across the South to Texas.

I took up genealogy several years ago when I was trying to get over a woman and cigarettes. It worked. A genealogy library makes a great recovery tank; you can't smoke in there, and the only humans you think about are dead. The impulse to find family, however, was genetic. It struck the day I began to gray, the morning mortality looked back in the mirror. It was time to find my place in the pantheon of my people.

I am not alone. In the South we worship genealogy like an "old-time" religion. Once only little gray-haired ladies congregated at card catalogs; now all types fill the pews around me - young and old. Some in the libraries are professional genealogists, hired guns tracking down other peoples' lives. Most are amateurs, but they research in a scholarly manner, following the facts of their families to whatever door steps they lead-plantation manor or creek-side cabin. I suspect a diminishing few, however, still prune family trees of unsightly limbs, like horse thieves, and graft onto ancestral charts the rich, royal, and famous. As for me, I care not about blue blood, and I would be neither surprised nor chagrined to find some ancestor's name on a police blotter. I have simply wanted to learn where and how my people lived.

It hasn't been easy. I descend from poor-to-middling cotton farmers who moved a lot and possessed a cavalier regard for education. Thus, they didn't leave behind many records, but they did sow a few memorable stories in the wagon ruts along their way west. From the clues left, I solved one family mystery and verified another family myth as fact. I even tracked an 18th century immigrant to County Antrim in Northern Ireland. Most important, I found Aunt Lillie. Nothing is more tedious than someone else's genealogy, so I'll be brief. I learned my great-great-great grandfather, Allen Leach, migrated from Walton County, Georgia, to Texas in 1854. As far as I knew, the Leach families in Georgia and Texas had completely lost touch. We finally spoke again when I placed an ad in the Walton County Tribune, outlining the family history, in hopes that some Georgia kin would call. Two days later, the telephone rang. "This is Ray Leach in Monroe," the voice said, "and I think I can help you."

On a cheerful, sunny weekend afternoon, my newfound Cousin Ray showed me a Leach family cemetery and the homeplace Allen left in 1854. Then Ray took me to meet his aunt, Lillie Leach Johnson.

When she opened the door, I looked again into the face of my long departed great-grandmother back in Texas: the same twinkling eyes, the same ladylike chuckie. Aunt Lillie welcomed us inside, and as I told the story of her great uncle, Allen Leach, and his exodus to Texas, she listened carefully, nodded, and replied as if it had occurred just a few years ago: "Well, we always wondered what happened to Allen."

Since then, I've brought my parents back to Walton County twice, where my mother has walked through her ancestral home. We've spent afternoons visiting with Ray and with Aunt Lillie, who, blessed with a wonderful wit, can tell great stories.

She told us this one last fall: "A few weeks ago, my granddaughter was driving me around down near Good Hope, and I said, "Have you ever seen a 99-year-old woman pick cotton? Well, you're about to." It was the first time in 45 years I had even wanted to pick cotton"

As we were leaving, Aunt Lillie. She gives flesh and voice to all those spools of microfilm, and she has made whole the long-broken circle of our family. We'll visit Aunt Lillie again on June 11, when she will put on her bonnet and walk out to a mailbox filled with birthday cards. That day, Lillie Leach Johnson turns 100. I hope it's a cheerful, sunny day.

Gray D. Ford

(Senior Travel Editor for "Southern Living". Gary Ford Still searches for family ties.)

(From: Southern Living, Southern Journal, 1993, p.188)

Federal Land Records, Part 1 of 3

Governmental Land Ownership.

When the thirteen colonies joined together to form the United States, a major concern for the new federal government was how to finance its operations. Responsibility for such things as customs and duties on commerce with other countries was the first of the many powers given up by the original states. For the new federal government to have an adequate source of revenue, it was necessary for the original states to cede (give up claim to) western lands they each claimed as their own. It was not easy to ask a land-rich state such as Georgia to give up its land without a fight. In fact, Georgia resisted longer than the other states, but as the last of the original states to ratify its constitution, it finally relinquished all claims to lands now comprising the states of Alabama and Mississippi.

This cession of public lands followed later by acquisition of additional territory gave rise to the two major classifications of **State Land** and **Public Land** states. In the State Land states, the states themselves hold title to and maintain records of all public land; in the Public Land states, the federal government holds title to and maintains records of public land.

"State Land" States.

Twenty of the fifty states are **State Land States**. The thirteen original states retained ownership of the public lands within their boundaries. An additional five states created from within the boundaries of the original thirteen states before the public lands were ceded to the federal government retained ownership of their public lands: Vermont, Maine, Kentucky, Tennessee, and West Virginia. Texas and Hawaii were special cases of independent republics being admitted to the Union. The Republic of Texas became a state land state as part of an exchange of land claims between the United States and the Republic of Texas. The Republic of Hawaii's well-established land divisions and ownership were honored as part of its annexation into the United States.

"Public Land" States.

The remaining thirty states are **Public Land States**. They were organized from the *public domain*, i.e., land in the areas which the original thirteen states ceded to the federal government or land which was obtained by the federal government after formation of the United States.

In 1787, the first western areas ceded by the state governments were contained in the "Territory Northwest of the Ohio River." This land became the first block of land to be sold by the federal government. Several experiments in how to survey the land and how to dispose of it to private parties took place in the Northwest Territory.

The short-lived "Territory Southwest of the Ohio River" became the state of Tennessee, which retained the right to the land because it had been part of North Carolina.

Prior to 1803, the western boundary of the United States was the Mississippi River, and virtually all of the original states held claims that extended that far west. In fact, several of the states claimed the same land areas. A compelling reason for creating a federal government was to have an arbitration body for disputes between the new states. The arbitration of land claims became one of the first major success stories of the fledgling United States government. Of course, the federal solution was to simply take over control of the disputed land claimed by the states.

All of the vast areas added later to the United States by the Louisiana Purchase, the war with Mexico, and the acquisition of Florida and Alaska became Public Land states.

"Metes and Bounds" Measurement.

The thirteen colonies that joined together to form the United States inherited from earlier British, Dutch, French, and Spanish governments, the "*metes and bounds*" system of land measurement. (The term *metes* means to measure or to assign a measure, while the term *bounds* refers to boundaries; thus a metes and bounds description gives the measurements and limits of the outside boundaries of a tract of land.¹) This system of land measurement is based on the lay of the land, including streams, trees, roads, rocks, and natural or

¹ "Surveying Fundamentals," Jack C. McCormac, Prentice-Hall, Englewood Cliffs, NJ, 1983, pg. 296.

man-made features as points of reference for identifying a piece of property.

In colonial America, the manner of obtaining land from the governments involved and the methods of describing land grants varied widely. Tracts of land were generally irregular in shape except for some subdivision in town and cities, there was no system for controlling surveys, legal descriptions of land were often vague, boundary markers were not permanent, and measurements contained many mistakes.² These conditions led to frequent boundary line disputes and litigation.

The rectangular U.S. Public Lands Survey was developed to overcome the deficiencies of metes and bounds measurement. Although most property surveys in State Land states were made by metes and bounds, the U.S. Public Lands Survey was not applied to State Lands states because of the enormous problems involved in changing existing descriptions of countless thousands of tracts in those states (CT, DE, GA, HI, KY, MA, MD, ME, NC, NH, NJ, NY, PA, RI, SC, TN, TX, VA, VT and WV).

A Metes & Bounds Description.

There are two essentials of a metes and bounds description. First, the description must begin at a substantial known point that can be located later if the *marker* -- referred to by surveyors as a "*monument*" -- should be destroyed or removed. Second, the description must *close*; that is, the description, if followed step by step from corner to corner, must return to the place it begins.³

The beginning point of the metes and bounds description on this page is a pine stump marking the corner where Mary Rader's land abuts Jacob Bare's. It lacks the permanency that a monument should have and illustrates how a boundary dispute could arise years later after the stump rotted away and no longer defined the boundaries between these three plots.

The description does meet the second essential of closing. The metes and bounds of this land can be plotted on paper using a ruler and protractor. When this is done, the description does close, i.e., it arrives back at the point of beginning.

The description which follows is a part of the *metes & bounds* of land owned by George Rader, Sr., in northern Rockingham County, VA -- a State Land state. A few

years after his death, his seven heirs in 1831 divided the land into very irregular sizes and shapes. This division, in the opinion of the heirs, created plots of equal value although sizes and shapes varied. They were thus able to compensate for varying topography, water supply, amount of timber, and amount of cleared land. Shown below is one of the two plots received by the oldest son Abraham.

1831 Rockingham County, VA, Deed

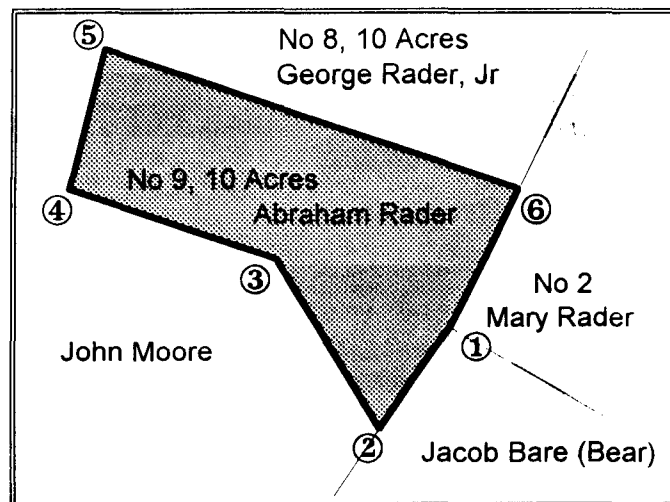

(Circled numbers added to plot and text for illustration.)

"An other lot of land...Containing Ten acres No 9 on Sd Plot and Bounded as follows to wit ① Beginning at a Pine Stump Corner & said tract No 2 Also a corner to Jacob Bare land and extending thence with his lines S 35½° W 24 poles to ② a Black oak in Said Bares line a Corner to John Moore then with Sd Moores line N 25½° W 36 poles to ③ two pines in Said Moores Corner thence with an other of his lines N 66½° W 35 poles to ④ a pine & scrub oak at the head of a small hollow corner to Said Moors then with another of his lines N 16° E 17 2/10 poles to ⑤ a white oak and two hickory saplings then leaving Sd Moores lines S 68° E 67½ poles to ⑥ a stake in a field and then S 20½° W 19 poles to ① the beginning." (A pole and a rod = 16½ feet.)

The new Congress created our rectangular land measurement system early in our nation's history. You may find that you need to be able to locate ancestors' property using that system; we will describe its basics in the next issue.

Adapted from *Genealogy Bulletin*, Number 12, Oct-Nov-Dec 1991. "Reprinted by permission of the publisher, Dollarhide Systems, Bellingham, WA."

² Ibid., pg. 297-8.

³ "Land Measurement Manual," Chicago Title Insurance Company, Chicago, IL, 1971, pg. 1.

On to Richmond!

Four Centuries of Family History

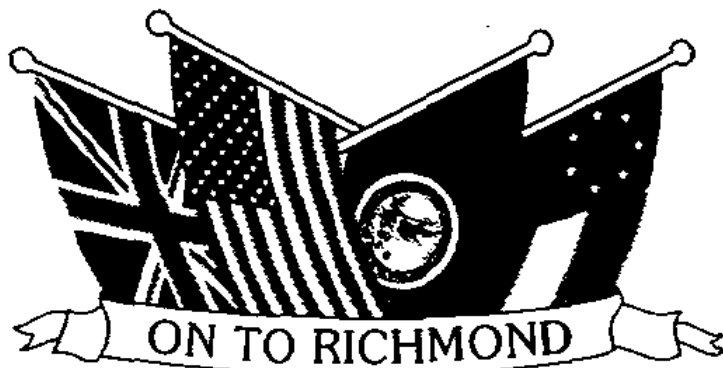

12-15 October 1994 ♦ Richmond, Virginia

The Federation of Genealogical Societies and the Virginia Genealogical Society proudly announce the 1994 *Conference for the Nation's Genealogists* to be held 12-15 October 1994 in Richmond. Genealogists from all over the country will gather there to enhance their research skills, further their knowledge of resources, and share in the genealogical excitement generated by a national conference.

Featuring:

More than 50 nationally known lecturers and regional experts
More than 120 sessions geared to every skill level -- novice to professional
Excellent Richmond-area research facilities and historical sites
Unique pre-conference Society Management Seminar
Abundant genealogical products and supplies in the exhibit hall

To receive the registration materials in Spring 1994, contact:

On to Richmond!
Federation of Genealogical Societies
P.O. Box 3385
Salt Lake City, UT 84110-3385
Phone 801/254-2785

A Conference for the Nation's Genealogists

COMPUTERS

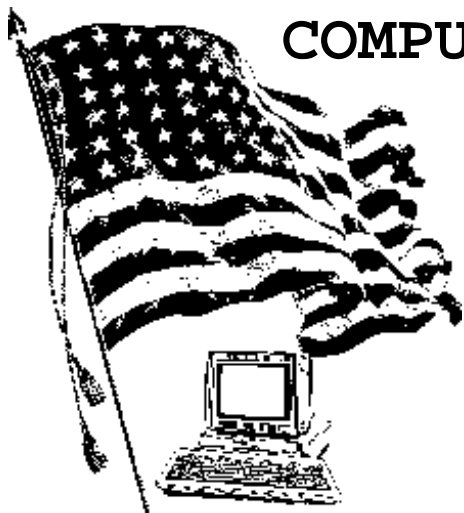

CompuServe Genealogy Forum MS-DOS and Windows Genealogy Programs

By Dick Eastman, CompuServe 76701,263

Introduction

Overview

The Sysops of CompuServe's Genealogy Forum often get asked about available genealogy software for PC clones. We get asked "Which is best?" or "Which one has specific features?" In an attempt to answer these questions and to provide a ready reference of the available genealogy programs, I have compiled this list of all the available Windows, OS/2 and MS-DOS genealogy programs.

This list is as accurate and complete as I could possibly make it. It lists all the known genealogy programs as of April 19, 1993. Please keep in mind that more programs and updated programs appear almost daily! Revision numbers also change frequently as the programmers add new features and correct bugs discovered by users. The names of the files available for downloading from CompuServe's Genealogy Forum change frequently as new revisions are uploaded. If you have any questions about the file names listed here, drop a note to the Sysops on the Genealogy Forum to obtain the latest file name.

When contacting any of the vendors listed here, please tell them that you obtained information from the software list maintained on CompuServe's Genealogy Forum.

GEDCOM

Serious genealogists will usually caution newcomers to select programs that support importing and exporting of GEDCOM files. GEDCOM (Genealogy Data COMMunications) is a more-or-less standardized file format that allows dissimilar programs to exchange genealogy data. It is possible to create a GEDCOM file on a PC clone and then later import that GEDCOM data into a different genealogy program on a PC clone, a Macintosh, an Amiga or an Atari computer, assuming that the receiving program also supports GEDCOM.

The GEDCOM utilities are the responsibility of the author of each genealogy program, there are some significant differences in the GEDCOM implementation of various programs. No GEDCOM-

compatible program will transfer 100% of the data, but most will create an error log of the info not handled. Reviewing this log can be a great help in recreating any missing data.

After typing in thousands of individual's records on one program, you might wish to experiment with a different program or to "trade up" to a program with more features. If both programs support GEDCOM, data can be moved from one to the other without re-keying all the data in again. The genealogy newcomer is strongly advised to consider GEDCOM capabilities in making a selection.

GEDCOM creates an ASCII file that can be read by many word processors or "file viewer" programs. However, the data is in a format that is very difficult to read with the human eye.

GEDCOM also allows for submission of a personal database to the Ancestral File that is maintained by the Church of Jesus Christ of Latter-day Saints. Where known, the availability of GEDCOM for any genealogy program has been included in this list.

Copyright

This list is copyright 1993 by Richard W. Eastman and CompuServe Information Systems, Inc. It may be freely distributed provided that the file is not altered in any way and that full credit is given to the Genealogy Forum on CompuServe.

Endorsement

The listing of software in this file does not constitute an endorsement. Some of this software has not been examined by this author.

Updates

The file names shown in this document are the names employed on CompuServe's Genealogy Forum. These are the names used in Library 2 (New Uploads) and Library 3 (MS-DOS Software) at the time this document was prepared. The names may differ elsewhere. Also, new revisions frequently will involve new file names. If you find any of this information to be in error or outdated, please leave a message to: SYSOP on CompuServe's Genealogy Forum.

(To Be Continued in October)

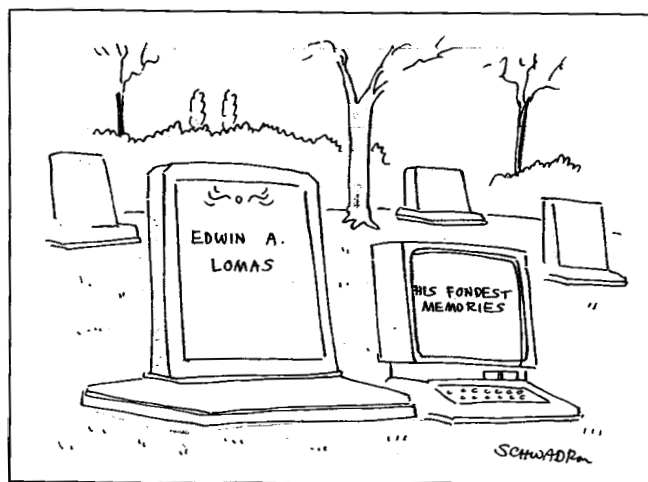

88 COMPUTE! JANUARY 1993



1994-1995 CCNGS Calendar of Events



July 1994

S	M	T	W	T	F	S
						1 2
3	4	5	6	7	8	9
10	11	12	13	14	15	16
17	18	19	20	21	22	23
24	25	26	27	28	29	30
31						

August 1994

S	M	T	W	T	F	S
	1	2	3	4	5	6
7	8	9	10	11	12	13
14	15	16	17	18	19	20
21	22	23	24	25	26	27
28	29	30	31			

September 1994

S	M	T	W	T	F	S
				1	2	3
4	5	6	7	8	9	10
11	12	13	14	15	16	17
18	19	20	21	22	23	24
25	26	27	28	29	30	

October 1994

S	M	T	W	T	F	S
						1
2	3	4	5	6	7	8
9	10	11	12	13	14	15
16	17	18	19	20	21	22
23	24	25	26	27	28	29
30	31					

November 1994

S	M	T	W	T	F	S
		1	2	3	4	5
6	7	8	9	10	11	12
13	14	15	16	17	18	19
20	21	22	23	24	25	26
27	28	29	30			

December 1994

S	M	T	W	T	F	S
				1	2	3
4	5	6	7	8	9	10
11	12	13	14	15	16	17
18	19	20	21	22	23	24
25	26	27	28	29	30	31

July

-
- 4 Jewish Genealogical Society Meeting (896-1899)
 - Independence Day**
 - 13 6:30pm Southern Nevada PAF User Group Meeting (641-7377)
 - 21 7:00-9:00pm CLARK COUNTY NEVADA GENEALOGICAL SOCIETY MEETING
 - 7:00pm Member Resources

August

-
- 1 Jewish Genealogical Society Meeting (896-1899)
 - 10 6:30pm Southern Nevada PAF User Group Meeting (641-7377)
 - 14 97th Annual WHITELEATHER Reunion
Contact: Shirley Fox 1-216-894-2557
 - 18 7:00-9:00pm CLARK COUNTY NEVADA GENEALOGICAL SOCIETY MEETING
 - 7:00pm Children's Books and Genealogy

September

-
- 5 Jewish Genealogical Society Meeting (896-1899)
 - Labor Day**
 - 6 **Rosh Hashanah**
 - 14 6:30pm Southern Nevada PAF User Group Meeting (641-7377)
 - 15 **Yom Kippur**
 - 7:00-9:00pm CLARK COUNTY NEVADA GENEALOGICAL SOCIETY MEETING
 - 7:00pm Birthday Pot Luck - Election and Installation
 - 23 **Autumn begins**

October

-
- 1 FAMILY HISTORY MONTH PROCLAIMED IN NEVADA FALL SEMINAR
 - 3 Jewish Genealogical Society Meeting (896-1899)
 - 10 **Columbus Day (Observed)**
 - 12 6:30pm Southern Nevada PAF User Group Meeting (641-7377)
 - 20 7:00-9:00pm CLARK COUNTY NEVADA GENEALOGICAL SOCIETY MEETING
 - 30 **Daylight Savings--set back 1 hour**
 - 31 NEVADA'S 130th BIRTHDAY (Born 1864)
 - Halloween**

November

-
- 7 Jewish Genealogical Society Meeting (896-1899)
 - 8 **Election Day**
 - 9 6:30pm Southern Nevada PAF User Group Meeting (641-7377)
 - 11 **Veterans Day**
 - 17 7:00-9:00pm CLARK COUNTY NEVADA GENEALOGICAL SOCIETY MEETING
 - 7:00pm Deeds & Land Records
 - 24 **Thanksgiving**
 - 28 **Hanukkah**

December

-
- 5 Jewish Genealogical Society Meeting (896-1899)
 - 14 6:30pm Southern Nevada PAF User Group Meeting (641-7377)
 - 15 7:00-9:00pm CLARK COUNTY NEVADA GENEALOGICAL SOCIETY MEETING
 - 21 **Winter begins**
 - 25 **Christmas**
 - 31 **New Year's Eve**

January

-
- 1 **New Year's Day**
 - 16 **Martin Luther King, Jr.**

January 1995

S	M	T	W	T	F	S
1	2	3	4	5	6	7
8	9	10	11	12	13	14
15	16	17	18	19	20	21
22	23	24	25	26	27	28
29	30	31				

February 1995

S	M	T	W	T	F	S
				1	2	3 4
5	6	7	8	9	10	11
12	13	14	15	16	17	18
19	20	21	22	23	24	25
26	27	28				

March 1995

S	M	T	W	T	F	S
				1	2	3 4
5	6	7	8	9	10	11
12	13	14	15	16	17	18
19	20	21	22	23	24	25
26	27	28	29	30	31	

April 1995

S	M	T	W	T	F	S
						1
2	3	4	5	6	7	8
9	10	11	12	13	14	15
16	17	18	19	20	21	22
23	24	25	26	27	28	29
30						

May 1995

S	M	T	W	T	F	S
	1	2	3	4	5	6
7	8	9	10	11	12	13
14	15	16	17	18	19	20
21	22	23	24	25	26	27
28	29	30	31			

June 1995

S	M	T	W	T	F	S
				1	2	3
4	5	6	7	8	9	10
11	12	13	14	15	16	17
18	19	20	21	22	23	24
25	26	27	28	29	30	

NEVADA STATE HEALTH DIVISION
Section of Vital Statistics
505 E. King St., Rm. 102
Carson City, Nevada 89710
(702) 687-4480

DEATH CERTIFICATE APPLICATION No. of Copies _____
\$8.00 per Certified Certificate

Search fee when no record is found.....\$4.00 per name

FULL NAME OF DECEDENT _____

DATE OF DEATH _____

PLACE OF DEATH _____
(City or County)

DECEDENT'S MOTHER'S MAIDEN NAME _____
(First, Middle & Last)

MORTUARY IN CHARGE OF ARRANGEMENTS _____

ADDRESS _____

Purpose for which certificate is to be used _____

Mailing Address _____
(This section **MUST** be completed)

Signature of Applicant _____

Relationship to Decedent _____
(Parent, Spouse, Child, Executor, Attorney, etc.)

For Office Use Only:

Amount Received _____ Receipt No. _____

Copies Ordered _____ Date _____

NEVADA STATE HEALTH DIVISION
Section of Vital Statistics
505 E. King St., Rm. 102
Carson City, Nevada 89710
(702) 687-4480

BIRTH CERTIFICATE APPLICATION No. of Copies _____
\$11.00 per Certified Copy
\$11.00 per Certified Card

Search fee when no record is found.....\$4.00 per name

FULL NAME AT BIRTH _____

DATE OF BIRTH _____

PLACE OF BIRTH _____
(City or County)

FATHER'S NAME _____

MOTHER'S MAIDEN NAME _____
(First, Middle & Last)

ATTENDING PHYSICIAN OR MIDWIFE _____

Purpose for which certificate is to be used _____

Mailing Address _____
(This section **MUST** be completed)

Signature of Applicant _____

Relationship _____
(Mother, Father, Self, etc.)

For Office Use Only:

Amount Received _____ Receipt No. _____

Copies Ordered _____ Date _____

SURNAME INDEX

THE PROSPECTOR

VOL. 14 NO. 3, JULY 1994

A

ALLAM 8
ALLAN 5
Allen 7
AMERSON 1
AUSTIN 10

B

BALKE 10
BARCUS 1, **CCNGS**
BENTZ 10
BIRK 1
BRIZENDINE 10
BRUER 10
BURNETT 5
BURT 1
BYRGE 1

C

Cheek 7
COLLING 1
CORCORAN 10
CRAWFORD 5
CRIPE 5
CROSBY 10
Cullings **CCNGS**
CUPP 10

D

DAHIR 8
DAVIS 1
DILLY 5
DIMITT 1, **CCNGS**
DIMON 1
DWYER 10

E

Eastman 16
EDMONSON 1, **CCNGS**

F

FAGER 1
FARRELL 10
Ferguson 4
Ford 12
FRANK 1
FREITAG 10
Fretwell 3

G

GAYTON 10
GIBSON 5
GILLIGAN 10
Gilruth 4
GOOD 1
GORDON 1
GRAVEN 1
GRAVES 10
GRAY 5
GREENE 1
GRIFFITH 10

H

HAEFNER 1
HALLSTED 2
Hamilton 4
HARRISON 10
HART 1
HAWKINS 1
Hawkins **CCNGS**
HAYDEN 5
HEATH 1
Hill **CCNGS**
HONEA 1
HUMPHREY 5
Hynes 3

K

KELLY 1
KENNARD 1, **CCNGS**
KLINETOB 10
KLOK 9
KLOOK 9
KOCK 9
KOSTESCH 10
Kraemer **CCNGS**
KROEGER 8, 9
KROHN 8, 9
KRUEGER 8

L

LAING 5
LAMBERT 10
LANG 1, **CCNGS**
LANGDON 5
LARSON 10
Leach 12
LEAVENS 1

LESAU 9
LOUIS 1, 5

M

MADDOX 10
Malcolm 4
MARSHALL 6
Martinez 2
MATHIS 10
McCarthy **CCNGS**
McCLAIN 10
McEwen **CCNGS**
MILLER 5
MOELLER 8, 9
MOORE 1
MORROW 1
MORTON 5

O

OWEN 10

P

Patrick 4
PIERCE 10
PIPKINS 10
PRITCHETT 1
PROSCH 8, 9
PURSEL 1
Pursel **CCNGS**

R

RAMS 1
Ramsbotham 4
RAQUELD 5
REDDY 10
RICKETTS 5
RINALDI 5
ROBBINS 1
Roberts 4
ROCKHOLD 5
ROGERS 5
ROOT 5
ROSNER 1, **CCNGS**
RUSH 1
Ruthven-Murray 4

S

SABAGH 8
SAIDY 8, 9

Saul 4
SAYE 1, **CCNGS**
SCAROLA 1
Scherer 7
SCHMALFELD 9
SHEA 10
SHOKS 10
SILVER 5
SIMPSON 10
SKYRLOCK 10
SLADE 5
SMITH 1, 10, **CCNGS**
SOROFMAN 1
STEINBOCK 9
STEINER 5
Stevens **CCNGS**
STOLTEN 9
SYZDEK 1, **CCNGS**

T

TEGEN 9
THOMPSON 10
THORSTEINSON 1, 10
THUN 5

V

VOGEL 5
VOORHEES 1, 10

W

WALLEY 5
Warwick 3
WELCH 5
WELLS 5
WHIPPLE 1
WHYTE 5
WINTERS 5
Wolfgram 7
WOLPERS 10
WRIGHT 1

Clark County, Nevada, Genealogical Society

Box 1929 -- Las Vegas, NV 89125-1929

Annual membership in the CCNGS is \$16.00 for individuals; \$19.00 for families.

Life memberships are \$200.00 for individuals; \$250.00 for families.

Cost of queries in the CCNGS quarterly, the "Prospector" -- members, no cost -- non-members \$1.00 per query per issue.

Space may require that we limit queries to three queries per person per issue.

Request for Research Assistance

CCNGS File Number _____

Amount Enclosed \$ _____

Your Name and Address: _____

Research Assistance Requested -- be as specific as you can --
use another page if additional space is needed:

The CCNGS fee for research assistance is \$10.00. The fee covers the society's or the volunteer researcher's costs of preparing replies, making copies, providing forms, and mileage and parking expense. If costs exceed the amount remitted, we will contact you before incurring added costs. Include with your request the non-refundable fee, this completed form, and a SASE (Self-Addressed-Stamped-Envelope).

CCNGS has no members who do research for pay. For this reason, we are not able to undertake major genealogy or family history research projects. If you need an answer to a specific genealogy or family history question, one of our member volunteers will try to locate it for you. Some of the information sources available locally include newspaper microfilm and indexes, telephone directories, a few city directories, book and manuscript collections, property records and voter registrations.

Before returning this form to CCNGS, please complete the preliminary steps needed for us to assist you:

1. Provide us with a Family Group record, Pedigree Chart or other summary telling us why you think the records you are seeking will be found in Las Vegas or Clark County.
2. Research censuses for your ancestor at your local library, LDS Family History Center, genealogy or historical society ("The Handy Book for Genealogists," Everton Publishers, Logan, UT, lists addresses). Southern Nevada was a part of Utah or New Mexico Territories in 1850 & 1860; Lincoln County, NV, in 1870, 1880 & 1900; and Clark County, NV, in 1910 & 1920.
3. Obtain copies of records directly from state and county agencies. There is frequently a fee for searching as well as the fee for a copy of the record itself. Please determine the complete date of death before you request a newspaper obituary search.

Birth Records (\$11.00 per copy, search fee when no record is found or year of birth is not known, \$4.00 per name) and ...

Death Records (\$8.00 per copy, search fee when year of death is not known, \$5.00 per name):

- 1867-1909 - Lincoln County Recorder, P.O. Box 218, Pioche, NV 89043 (702) 962-5495.
- 1909-1911 - Clark County Recorder, P.O. Box 551510, Las Vegas, NV 89155 (500 S. Grand Central Pkwy.) (702) 455-4336.
- After July 1911 - Nevada State Health Division, Section of Vital Statistics, 505 E. King St., Room 102, Carson City, NV 89710, (702) 687-4480. During the first 90 days after birth or death, obtain records from the Clark County Health District, Vital Records, P.O. Box 4426, Las Vegas, NV 89127 (702) 383-1223. The Clark County Health District retains birth records for only 25 years; death records for only 20 years -- only the Nevada State Health Division has earlier records.

Marriage Applications (\$3.00 per copy):

- 1873-1909 - Lincoln County Clerk, P.O. Box 90, Pioche, NV 89043 (702) 962-5390.
- Since 1909 - Clark County Clerk, P.O. Box 551601, Las Vegas, NV 89155 (500 S. Grand Central Pkwy.) (702) 455-3156.

Marriage Certificates (\$7.00 per copy) and ...

Divorce Decrees (\$1.00 per page plus \$4.00 for certification):

- 1873-1909 - Lincoln County Recorder, P.O. Box 218, Pioche, NV 89043 (702) 962-5495.
- Since 1909 - Clark County Recorder, P.O. Box 551510, Las Vegas, NV 89155 (500 S. Grand Central Pkwy.) (702) 455-4336.

Land Records & Deeds (Contact the County Recorder for costs):

- 1866-1909 - Lincoln County Recorder, P.O. Box 218, Pioche, NV 89043 (702) 962-5495.
- Since 1909 - Clark County Recorder, P.O. Box 551510, Las Vegas, NV 89155 (500 S. Grand Central Pkwy.) (702) 455-4336.

Probate Records (Contact the Nevada State Library or the District Court for costs):

- Before 1861 - Utah Territorial Courts (at the Nevada State Library & Archives, 101 South Fall St., Carson City, NV 89710).
- 1861-1909 - Seventh Judicial District Court, Pioche, NV 89043.
- Since 1909 - Eighth Judicial District Court, 200 South 3rd St., Las Vegas, NV 89101 (702) 455-4011.

Revised April 2001

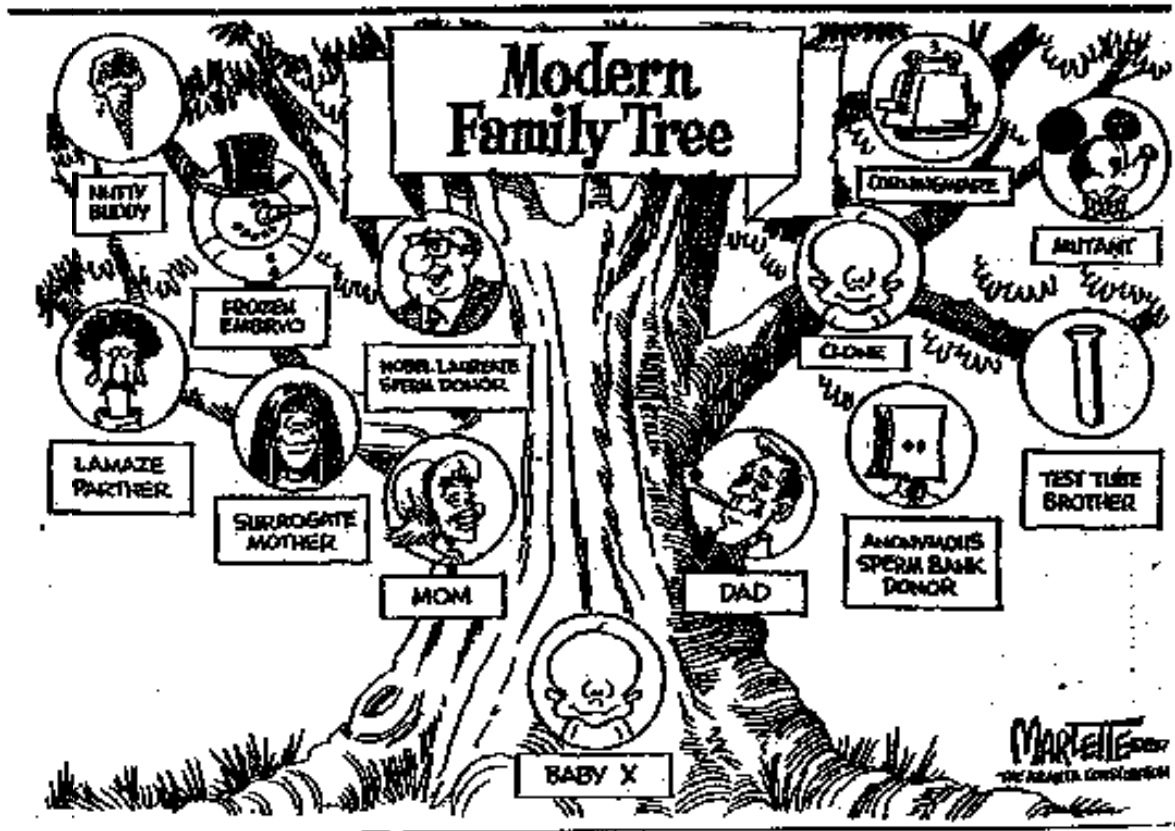

C.C.N.G.S.
 P.O. Box 1929
 Las Vegas, Nevada
 89125-1929

FORWARDING and RETURN POSTAGE GUARANTEED
 ADDRESS CORRECTION REQUESTED

