

LINCOLN WHITE PINE CLARK LYON

ORMSBY

PERSHING

LANDER

CHURCHILL

HUMBOLDT

EUREKA

ESMERALDA

MINERAL

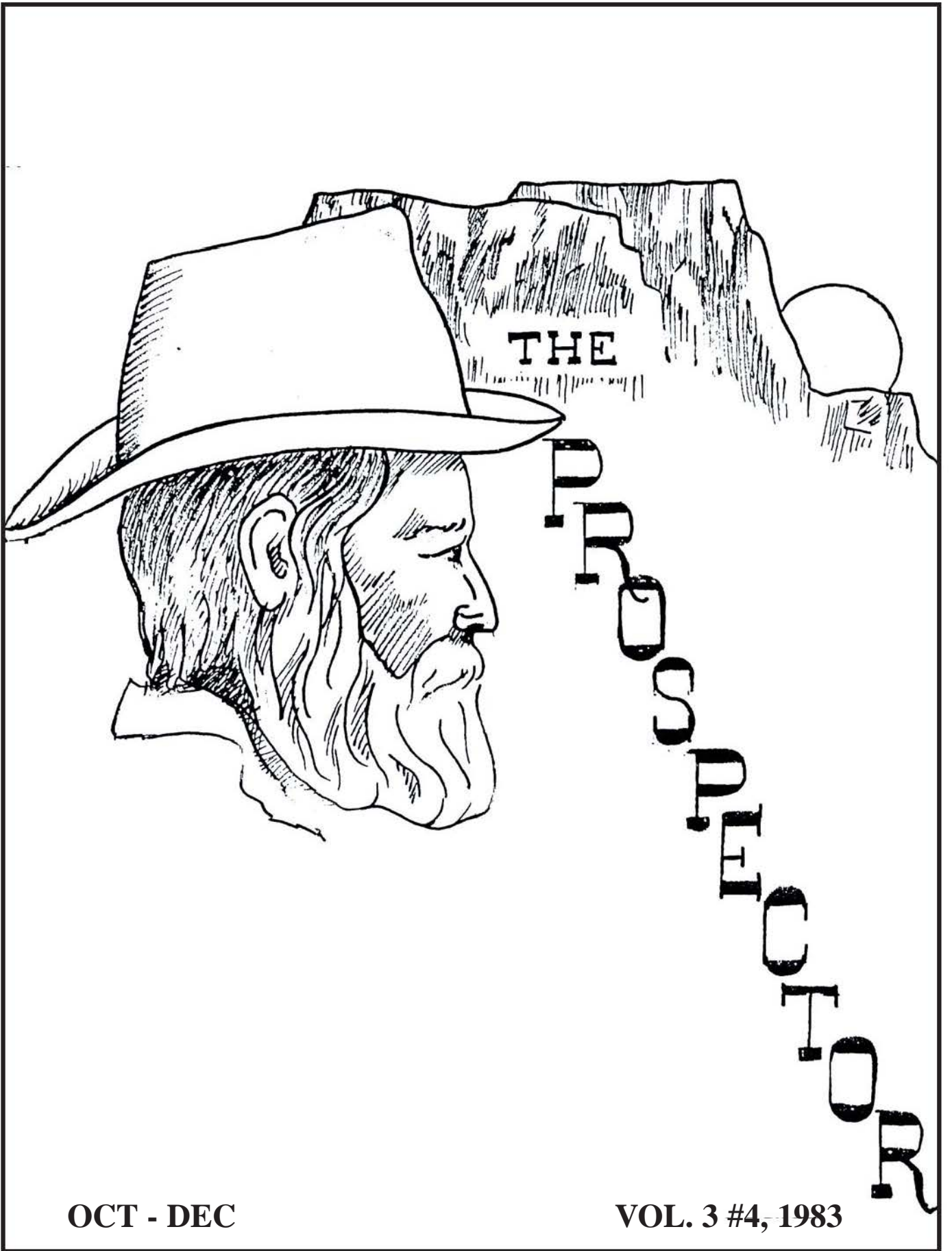

OCT - DEC

VOL. 3 #4, 1983

DOUGLAS WASHOE NYE ELKO STOREY



CLARK COUNTY NEVADA GENEALOGICAL SOCIETY

P.O. BOX 1929
LAS VEGAS, NEVADA 89125

THE PROSPECTOR

Officers:

President
V.P.
Secretary
Treasurer

Shirley Jaquess AYO
Linda Robinson McEWEN
Rosemary HANSEN
Catherine Allan MARSHALL

"Preserving for Posterity"

****NOTICE TO ALL MEMBERS****

We will no longer be able to mail out copies of our quarterly publication "The Prospector". You may receive your copy at the regular monthly meeting of the CCNGS. Please continue to support your Society by attending the meetings and bring a friend.

SHARING IS CARING

Our thanks goes to one of our new members, Ramona Armstrong Duff, for sharing her AHENTAFEL chart with us. (See the chart on page 2 in this issue.)

Ramona comes to us from the Sacramento Genealogical Society, where she was that group's president before her husband's transfer to Las Vegas. Sacramento's loss is our gain and we extend a hearty welcome to Ramona and to all of our other new members.

SHARING IS CARING--SPECIAL!!

Another one of our new members came to our rescue at the September meeting. Due to a conflict in scheduling, at the last minute, our regular meeting room at Crestwood School was not available. Forest Baker offered us the hospitality of his home for the meeting that evening.

The meeting was even more enjoyable, as the members had the opportunity to peruse the genealogy that Forest has collected in less than a year!

A SPECIAL THANKS TO YOU, FOREST!

MEETING SCHEDULE_____

Nov 9	Tour of Special Collections_UNLV-7p.m. (Please note time)
Dec 13	Christmas Party
Jan 10	Open

The following AHNENTAFEL was submitted for publication by Ramona Armstrong Duff.

An Ahnentafel is a German word meaning Pedigree, but is found in a different form than the charts we are all used to working with. This form lists all the ancestors in a single column, each with their own number. In order to use this form, if you want to find a person's parents, that person's father would have a number that is double his own number. His mother's number is then double, plus one of his own. Such as: #15, Mary Ellen Dorsey is the daughter of #30, Augustus Dorsey and his wife, #31, Frances Minerva Shultz.

Using this form in lieu of the standard charts, you can get an equivalent of probably 16 - 20 charts onto only 3 or 4 pages.

Ramona has started her ahnentafel with her children instead of herself, so that she has both her own and her husband's lines on the same chart.

1. Michael Terry DUFF, and Deborah Deanne DUFF WOHN
2. Cecil Austin DUFF, Jr., b. 2 Aug. 1931 Okla. City, Okla.; m. 6 March 1955
3. Ramona Lee ARMSTRONG, b. 15 Jan. 1934 Hydro, Caddo Co., Okla.
4. Cecil Austin DUFF, Sr., b. 25 Feb. 1904 Mineola, Wood Co., Texas; m. 9 Aug. 1925 Shawnee, Pottowatomie Co., Okla.; d. 4 Sept. 1946 Okla. City, Okla.
5. Essie Mae COOPER, b. 5 Jan. 1910 Dierks, Sevier Co., Ark.
6. Mansel Grant ARMSTRONG, b. 30 Aug. 1897 Arapaho, Okla. Territory; m. 17 Oct. 1920 Hydro, Caddo Co., Okla.; d. 13 Feb. 1977 Okla. City, Okla.
7. Ethel Marguerite LIGHT, b. 11 Dec. 1900 Geary, Blaine Co., Okla.
8. John Newton DUFF, b. 4 Sept. 1879 Wood Co., Texas; m. 16 Nov. 1899 Hunt Co., Texas; d. 29 Dec. 1947 El Reno, Canadian Co., Okla.
9. Mabel TAYLOR, b. 18 Sept. 1883 Collinsville, Grayson Co., Texas; d. 21 April 1958 Shawnee, Pottowatomie Co., Okla.
10. George Andrew Jackson COOPER, b. 9 Dec. 1877 Newton Co., Ark.; d. 25 Jan. 1957 Shawnee, Pottowatomie Co., Okla.
11. Fannie Ellen WALDRON, b. 26 March 1882 Rolla, Maries Co., Missouri; d. 11 Mar. 1924 Shawnee, Pottowatomie Co., Okla.
12. John Franklin ARMSTRONG, b. 29 Aug. 1856 Knoxville, Knox Co., Ill.; m. 14 June 1892 Grant City, Missouri; d. 28 Jan. 1942 Clinton, Custer Co., Okla.
13. Anna Samantha TURNER, b. 19 Aug. 1870 Allendale, Worth Co., Missouri; d. 23 June 1942 Clinton, Custer Co., Oklahoma
14. William Russell LIGHT, b. 3 April 1861 Marion, Olmsted Co., Minn.; m. 4 Oct. 1897 El Reno, Canadian Co., Okla.; d. 2 Jan. 1934 El Reno, Canadian Co., Okla.
15. Mary Ellen DORSEY, b. 22 Jan. 1873 Lincoln, Lancaster Co., Neb.; d. 20 March 1928 El Reno, Canadian Co., Okla.
16. John Stephens DUFF, b. 25 Aug. 1839 Washington Co., Virg.; d. 26 Aug. (1882 or 1892) Wood Co. Texas
17. Mollie Victoria SANDERS, b. May 1858 Kentucky
18. Franklin B. TAYLOR, b. 9 Oct. 1858 Collinsville, Grayson Co., Texas; d. 22 May 1925 Shawnee, Pottowatomie Co., Okla.
19. Laura BROCK, b. 17 Dec. 1860 Tenn.; d. 29 Jan. 1948 Shawnee, Pott. Co., Okla.
20. George Monroe COOPER, b. 16 March 1852 Tenn.; m. 30 May 1875 Clarksville, Ark.; d. 29 Nov. 1947 Idabel, McCurtain Co., Okla.
21. Margaret Elizabeth KINDALL/KENDALL, b. 30 May 1858 Polk Co., Ark.; d. 9 Nov. 1942 Battiest, McCurtain Co., Okla.
22. William Hiram WALDRON, b. 1852 Bedford Co., Virg.; m. ca. 1874 Missouri; d. ca. 1894 Yell Co., Ark.

23. Ella Louise ARNOLD, b. 18 Feb. 1849 Richmond, Macomb Co., Mich.; d. 17 April 1935 Stratford, Pontotoc Co., Okla.
24. John ARMSTRONG, b. 30 Nov. 1819 New York; m. ca. 1853 Illinois; d. 22 Jan. 1889 Bethany, Harrison Co., Missouri
25. Nancy Ann MORRIS, b. 21 Sept. 1829 Ohio; d. 27 Aug. 1891 Bethany, Harrison Co., Missouri
26. Reuben Webster TURNER, b. 1829 Fayette Co., Indiana; m. 20 Dec. 1861 Vigo Co. Ind.; d. 1905 Washita Co., Okla.
27. Margaret Ellen PARKER, b. 7 Nov. 1843 Vigo Co., Ind.; d. 27 April 1926 Foss, Washita Co., Okla.
28. Oliver Perry LIGHT, b. 7 April 1828 Clermont Co., Ohio; m. 6 Sept. 1853 Shelbyville, Shelby Co., Ill.; d. 28 March 1904 Wymore, Gage Co., Neb.
29. Nancy Jane PRATHER, b. 12 Sept. 1833 Clark Co., Indiana; d. 4 Aug. 1895 Wymore, Gage Co., Neb.
30. Augustus DORSEY, b. 30 Dec. 1841 Somerset Co., Penn.; m. 22 Oct. 1868 Dixon, Lee Co., Ill.; d. 2 July 1924 Conway Springs, Sumner Co., Kansas
31. Frances Minerva SHULTZ, b. 1 April 1849 Somerset Co., Penn.; d. 7 June 1878 Lincoln, Lancaster Co., Neb.
32. John Newton DUFF, b. ca. 1806 Virg.; m. Oct. 1827 Washington Co., Virg.
33. Eliza M. CLARK, b. ca. 1812 Virginia
36. Joseph TAYLOR, b. ca. 1825 Kentucky
37. Nancy C. _____, b. ca. 1825 Virginia
38. Harrison BROCK, b. ca. 1827 N. Carolina
39. Julia BEWLEY, b. ca. 1839 Tennessee
40. Rufus R. COOPER, b. ca. 1822 Tennessee
41. Martha J. _____, b. ca. 1830 Alabama
42. Epaphroditus Theopolis KENDALL, Jr. b. June 1836 Saline Co., Ark.
43. Anna Jane AVANTS, b. ca. 1838 Tennessee; d. ca. 1863 Arkansas
44. Moses WALDRON, b. ca. 1830 Bedford Co., Virg.; m. 7 Sept. 1847 Bedford Co., Virg.; d. after 1900 Maries Co., Missouri
45. Nancy PEARCY, b. ca. 1820 Bedford Co., Virg.; d. ca. 1881 Maries Co., Missouri
46. Elizur S. ARNOLD, b. 25 Feb. 1805 Chatham, Middlesex Co., Conn.; m. 22 Jan. 1843 Macomb Co., Mich.; d. after 1880 Missouri
47. Betsy ROBERTS, b. ca. 1813 New York; d. after 1880 Missouri
49. Mary BARRON, b. ca. 1800/01 Geneva, New York
52. Greenville Person TURNER, b. ca. 1797 Virg.; m. 19 Aug. 1815 Franklin Co., Virg.; d. 1877 Fincastle, Putnam Co., Indiana
53. Deborah WEBSTER, b. ca. 1796 Virginia; d. ca. 1836 Putnam Co., Indiana
54. Greenberry PARKER, m. 11 Dec. 1834 Monroe Co., Indiana
55. Elizabeth WILLOUGHBY, b. ca. 1810 Tenn.; d. 1900 Worth Co., Missouri
56. David LIGHT, b. 5 Sept. 1800 Clermont Co., Ohio; m. 6 Dec. 1821 Clermont Co., Ohio; d. 16 Sept. 1888 Edgar Co., Illinois
57. Harriet DICKINSON/DICKENSON, b. 20 Nov. 1801 Wyoming, Ontario Co., New York; d. 26 Jan. 1873 Edgar Co., Illinois
58. James Russell PRATHER, b. 17 Nov. 1807; m. 11 Feb. 1830, Clark Co., Indiana; d. 25 Jan. 1850 Jefferson Co., Iowa
59. Louvica Caroline VEATCH, b. ca. 1808 Kentucky; d. 15 July 1841
62. Joseph SHULTZ, b. 20 May 1819 Lavansville, Somerset Co., Penn.; m. 1841; d. 22 Aug. 1902 Dixon, Lee Co., Illinois
63. Catherine HANNA, b. ca. 1819/20 Penn.; d. 24 June 1862 Lavansville, Somerset Co., Penn.
64. John DUFF, b. 3 Jan. 1773 Washington Co., Virg.; m. 2 Jan. 1794 Washington Co., Virg.; d. 20 Aug. 1849 Washington Co., Virg.
65. Mary DRYDEN
76. James R. BROCK, b. ca. 1807 North Carolina
77. Elizabeth _____, b. ca. 1808 N. Carolina

78. William C. BEWLEY, b. ca. 1808 Tenn.; m. 30 Jan. 1835 Jefferson Co., Tenn.
79. Luvinia A. PECK, b. ca. 1816 Tennessee
84. Epaphroditus Theopolis KENDALL/KINDLE d. ca. 1837 in Indian attack near Fort Gibson, Okla. Territory.
85. Anna TERRY, b. 26 Oct. 1813 Illinois; d. 7 Aug. 1896 Arkansas
86. Ison AVANTS
88. Beverly WALDRON, b. ca. 1750 Bedford Co., Virg.; d. Nov. 1836 Bedford Co., Virginia
89. Nancy M. GROOME m. 4 May 1829 Bedford Co., Virginia
90. Henry PEARCY, b. ca. 1776; m. 17 Dec. 1807 Bedford Co., Virg.; d. 15 Feb. 1859 Bedford Co., Virginia
91. Rachel GROSS
92. John ARNOLD, b. 8 April 1777 Chatham, Middlesex Co., Conn.; m. 27 Aug. 1803 Chatham, Middlesex Co., Conn.
93. Sally BAILEY, b. 16 Nov. 1781, Chatham, Middlesex Co., Conn.
94. Joel ROBERTS, b. ca. 1786 Vermont
98. William BARRON, b. Mar. 1756 England; d. 14 July 1833 Seneca, New York
99. Margery WILKENS, d. 1855
104. Rev. Wilson TURNER, Sr., b. ca. 1776; m. 12 April 1796 Bedford Co., Virg.; d. 1827 Franklin Co., Virginia
105. Elizabeth DOSS, b. ca. 1778
106. Samuel WEBSTER, b. 10 April 1749 Goochland Co., Virg.; m. ca. 1770 Powhatan Co., Virg.; d. 24 Jan. 1823 Franklin Co., Virginia
107. Susannah BAGBY, b. 3 Nov. 1759 Powhatan Co., Virg.; d. 12 Oct. 1823 Franklin Co., Virginia
110. Elijah WILLOUGHBY, m. 19 Oct. 1787 Fauquier Co., Virg.; d. 1834 Monroe Co., Indiana
111. Susannah LEACHMAN, d. after 1835 Indiana
112. Jacob LIGHT, b. 10 Aug. 1756 Lancaster, Penn.; d. 19 March 1831 New Richmond, Clermont Co., Ohio
113. Catherine HARMAN/HARMON, b. 15 March 1764 Lancaster, Penn.; d. 21 July 1833 New Richmond, Clermont Co., Ohio
116. Lloyd Benton PRATHER, b. 25 Nov. 1782 Rowen Co., N. Carolina; m. 21 June 1804 Louisville, Jefferson Co., Kent.; d. 25 April 1867 Douglas Co., Kansas
117. Nancy REDMAN, b. 16 March 1782 Montgomery Co., Maryland; d. 11 Aug. 1871 Douglas Co., Kansas
118. Jacob VEATCH, b. ca. 1781 Woodford Co., Kent.; m. 19 Dec. 1805 Jessamine Co., Kent.; d. Clark Co., Indiana
119. Polly HILTON
124. Conrad SHULTZ, b. 27 Oct. 1780 Tewkesbury, New Jersey; m. ca. 1819 Somerset Co., Penn.; d. 9 April 1853 Lavansville, Somerset Co., Penn.
125. Catherine KOOSER, b. 26 June 1786 Penn.; d. 1 Jan. 1865 Lavonsville, Somerset Co., Penn.
128. Samuel DUFF, b. ca. 1750 Washington Co., Virg.; m. ca. 1769 Washington Co., Virginia; d. 5 Jan. 1825 Washington Co., Virg.
129. Mary KNOX, b. Old Fincastle Co., Virginia; d. after 1799
170. John S. TERRY, b. ca. 1765 Virg.; m. 28 May 1797 Madison Co., Kent.; d. ca. 1840 Hot Spring Co., Arkansas
171. Frances "Fanny" GADDY, b. ca. 1785 Bedford Co., Virg.; d. ca. 1840 Hot Spring Co., Arkansas
176. Moses WALDRON
177. Mary
178. Jonathan GROOMS, b. 5 Feb. 1756 London, England; m. ca. 1779 Botetourt Co., Virg.; d. ca. 1833-40 Bedford Co., Virg.
179. Elizabeth MOON d. ca. 1836 Bedford Co., Virg.
182. Isaac GROSS

As previously noted, our November meeting will take place at the UNLU Library, in the Special Collections Room.

All members are asked to meet at 7 p.m. (this is half an hour earlier than our regular meeting time), in the lobby on the fourth floor of Dickinson Library.

The following, contributed by Laura Folk, is a partial listing of some of the collections that may be of genealogical interest:

2nd Floor-Reference Section (non-circulating)

Many dictionaries, encyclopedias and other reference books written in foreign languages. Many other books that may be of help.

3rd Floor-Periodicals (non-circulating)

Bound copies of historical/genealogical magazines for most states.

Microfilm-3rd Floor (non-circulating)

The "London Times" newspaper, Jan 1785 until present day.
 Many old Nevada newspapers from all over the state.

Copies of micro-fiche/micro-reels can be made for 10¢ per sheet, paper items Xeroxed for 5¢ per sheet.

A 12 page booklet describing the library may be obtained free of charge on the 2nd floor of the Library.

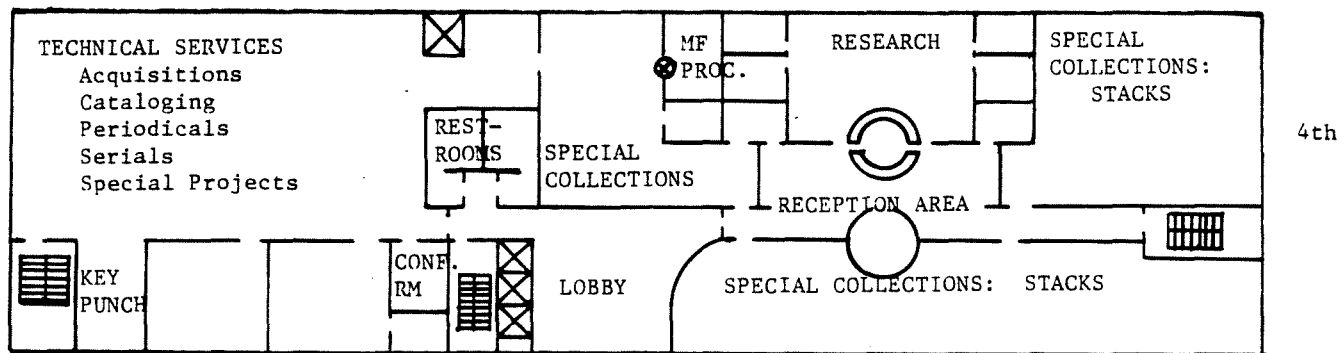

BIRTHS -NEVADA-1911-From the Las Vegas Age (published weekly)

	<u>Newspaper</u>	<u>Date</u>
JAMES, Rev. Paul & wife, girl, Ruth Evelyn 30 Jun	1 Jul, Pg. 1,	col.3
WILLIAMS, W.J. & Mrs., boy, 7 Jul	8 Jul, pg. 4,	col.4
WHITEHEAD, Mr. & Mrs. S.R., son, 5 Jul	8 Jul	
ALTER, Mrs. H.F., girl, 6 Jul, on train	8 Jul	
TABER, Hon. E.J.L. & Mrs., girl, 9 Jul	15 Jul, Pg. 1,	col.6
GRACE, Mr. & Mrs. Francis M., girl, 26 Jul	5 Aug, Pg. 1,	col.4
ARNOLD, Mr. & Mrs. W.E., boy, 21 Jul	5 Aug, Pg. 1,	col.5
1913 from the Las Vegas Age		
WOODS, Mr. & Mrs. Edward F., boy, 29 Dec 1912	11 Jan 1913	
GREENE, Mr. & Mrs. A.J., twin sons, 19 Jan	ca. 21 Jan, Pg. 4,	col.4
McCLURE, Mr. & Mrs George, boy, 19 Jan	"	
LOPEZ, Mr. & Mrs. Angel, girl, Margarita, 18 Jan	"	
KITTRELL, Mr. & Mrs. C.L., girl, 12 Jan	"	
CROSBY, Parents not given, boy, 11 Feb	1 Mar, Pg. 1,	col.1
MOORE, Mr. & Mrs. Leonard D., in Los Angeles, son, 20 Feb	"	
VON TOBEL, Mr. & Mrs. Ed, son, 11 Mar	15 Mar, Pg. 4,	col.4
CRONIN, Mr. & Mrs. D.B., girl, 14 Mar	22 Mar, Pg. 2,	col.2
BLEASDALE, Mr. & Mrs. B.G., girl, 29 May (?)	3 May 1913, Pg. 4,	col.3
DOHERTY, Mr. & Mrs. Frank, girl, 19 Jul (Alice Annice)	19 Jul, Pg. 3,	col.4
SANDERSON, Mr. & Mrs. George, girl, 24 Jul	26 Jul, Pg. 3,	col.4
FULLER, Dr. & Mrs. John A., boy, 14 Aug	16 Aug, Pg. 1,	col.5
MARTIN, Dr. & Mrs., girl, 5 Sep	6 Sep, Pg. 2,	col.1
BECHTEL, Mr. & Mrs. Henry, girl, 11 Sep	13 Sep, Pg. 3,	col.4
BALL, Mr. & Mrs. W.H., son, 13 Dec	13 Dec, Pg. 2,	col.2
AGUIRRE, Mr. & Mrs. Clato, son, 8 Dec	"	

McCARTHY, Mr. & Mrs. Chas. E., girl,	11 Dec	13 Dec, Pg. 2, col.2
O'LEARY, Mr. & Mrs. Dan J., girl,	29 Nov	29 Nov, Pg. 2, col.3
BARNES, Mr. & Mrs. Roy H. girl, Yellow		20 Dec Pg. 1, col.3
Pine Mining Dist., Goodsprings (no date)		
PIERCE, Mr. & Mrs. M.M., son,	13 Dec	27 Dec, Pg. 1, col.3
BIRTHS LAS VEGAS AGE 17 Aug 1912		
MALONE, Mr. & Mrs. Frank, son,		12 Aug, Pg. 1, col 5
BIRTHS LAS VEGAS AGE (exact date of paper unknown) 1914		
BALL, Mr. & Mrs. H.W., boy,		28 Oct, Pg. 3, col.2
BOYD, Mr. & Mrs. W.E., boy		30 Oct, Pg. 3, col.2
MARKT, Mr. & Mrs. Henry, boy,		30 Oct, Pg. 3, col.2
RICHARD, Mr. & Mrs. C.F., girl,		30 Oct, Pg. 3, col.2
BIRTHS LAS VEGAS AGE 24 Jan 1914		
PHILLIPS, Mr. & Mrs. George W., girl,		21 Jan, Pg. 1, col.2
CLAUBERG, Mr. & Mrs. C.D., boy,		21 Jan Pg. 1, col.2
BIRTHS LAS VEGAS AGE 31 Jan 1914		
EGLOFF, Mr. & Mrs. T.J., girl, 3		30 Jan, Pg. 3, col.3
BIRTHS LAS VEGAS AGE 7 Mar 1914		
BLAKE, Mr. & Mrs. F.M., girl,		6 Mar, Pg. ?, col.2
BIRTHS LAS VEGAS AGE 4 Apr 1914		
LEAVITT, Mr. & Mrs. Newell, boy		22 Mar, Pg. 1, col.5
TATE, Mr. & Mrs. Wm. T., girl,		22 Mar, Pg. 1, col.5
BIRTHS LAS VEGAS AGE 11 Apr 1914		
DEVERELL, Mr. & Mrs. George, girl,		8 Apr, Pg. 3, col.3
STEWART, Mr. & Mrs. Wm. J., girl,		10 Apr, Pg. 3, col.3
KITTRELL, Mr. & Mrs. C.L., boy,		10 Apr, Pg. 3 col.3

QUERIES

Policy: Annual membership dues of the CCNGS are \$8.00 per year, which includes a subscription to the PROSPECTOR. Non-members may purchase copies of the PROSPECTOR for \$1.50 per issue.

CLEGG, LESTER

Need parents, siblings, of Ellen CLEGG (of Cincinnati, Oh.). She marr. 1859, Edward LESTER (b. 20 Aug 1828, Covington, Kenton, Ky.). Place of marr unknown. ch.: Joseph, Elizabeth Ann, William, George H., Agnes. All ch. probably b. in San Berdino Co., Ca.

Laura Folk, 2725 Tonawah Ave., N. Las Vegas, Nv. 89030

BURCH, SOUTHERN

Any info. on John L. Burch, b. 1774, Stokes Co., N.C. M. Judith SOUTHERN (B. 1774). To Monroe Co., Ind., 1816. 10 ch.

Sbirley AYO, 1400 Pyramid Dr., Las Vegas, Nv. 89108

WYANT, ZIMMERMAN

William WYANT, b. 1849 Oh.; d. Aug., Ia., m. See. Amanda ZIMMERMAN b. Jun., Oh.; d. Ia. Could have lived in Lancaster Co., Pa., or Hancock Co., Oh. Maybe Penn-Dutch

Catherine MARSHALL, 1741 Ferrrell St., Las Vegas, Nv. 89106

LAKIN, LEE

Need info. on Abraham LAKIN, m. 1710, Prince Georges Co., Md., Martha LEE, dau. of Wm. & Ann ()LEE. Abraham d. ca. 1745; Md. Would appreciate info on any of these families.

Linda McEMEN, 1112 Nassau Dr., Las Vegas, Nv. 89108

Please send your queries and articles for publication in the PROSPECTOR to: CCNGS, P.O. Box 1929, Las Vegas, Nv. 89125